

HYLINE®

D E T A I L S M A K E P E R F E C T I O N



DETAILS MAKE PERFECTION

A complete range of minimalist window frames in aluminium.
Sliding door, corners, fixed, pivot doors, guillotines...



01. PROFILE	5
02. TECHNICAL DETAILS	39
03. GET IN TOUCH	84

HYLINE, MUCH MORE THAN A BRAND, WE
ARE AN EXPERIENCE, WE ARE AN IDENTITY
WITH SOUL AND CAPABILITY

“

**ONE MOMENT MORE,
ANOTHER CATALOGUE
TO INSPIRE YOU.**

”

Focusing on high tech, high design, high quality, after the fact that we wanted something international, something global, the desire to stand out and do something unique was great, a differentiating product that defied rules and standards.

We are inspired by artisans and the needs of modern architecture where vision without visual interruptions is essential for a harmony between interior and exterior spaces, natural light, contact with nature.

HYLINE was born with a mission: to listen, to develop, to work the need and the detail, to challenge the impossible and deliver according to expectations, to work towards the satisfaction of architects, partners and clients, to create and innovate. We have our eyes on the future and our sight beyond borders.



PROFILE

SÃO PAULO, BRAZIL

ARCHITECT: BERNARDES
ARQUITETURA
PHOTO: LEONARDO FINOTTI
TYPE: PRIVATE HOME

GRAND STRUCTURES

&

MINIMALIST DESIGNS

DETAILS MAKE PERFECTION.





ALDO CRISTALDO

ARCHITECT

Private Home, Paraguay.

"First HYLINE work in Paraguay designed from root based on containers. Metal structures were used in harmony with HYLINE systems, enhancing the interconnection of these two materials - iron and glass. HYLINE in this work made possible a specification of the architect in fulfilling the total opening of all the windows of the area."

Products: HYLINE SLIM
Architect: Aldo Cristaldo
Type: Private Home



ALFONZO AZQUETA

ARCHITECT

Private Home, Madrid, Spain.

“The house was conceived in a very hermetically manner towards the outside and completely opened to the interior of the plot, always looking for the privacy of the views. Hyline has provided windows able to combine large openings with little visual impact of the profiling. On the other hand, the windows and doors were integrated in both floors and ceilings with which the inner-outer relationship increases.”

Products: HYLINE 30
Architect: Alfonso Azqueta
Type: Private Home







ROMEU RIBEIRO & JOSÉ PEDRO MARQUES

REM'A ARQUITECTOS

Private Home, Guimarães, Portugal.

“The exogenous voids surround the social areas, enlarging the space and emphasizing the views. The endogenous voids surround the private areas. They are constructed by the upper volume, set in the higher level of this plot, sustained by a Shear Wall. This volume only has one entrance geometrically defined by a triangle shape. This option allows us to control the light and emphasizes the relation with the surrounding constructions.”

Products: HYLINE 40

Architect: REM'A ARQUITECTOS - Romeu Ribeiro & José Pedro Marques

Type: Private Home



DIEGO TOBAL

ARCHITECT

Private House "La Zagaleta", Marbella, Spain.

"We started from a precise concept: large projections on powerful walls that collect tall and discrete windows.

We coordinated with AIU AND GLASS and its technical team from the initial stages of the design process, ensuring that the transition from idea to reality did not lose the purity we were looking for".

Promotor: PrestigeExpo
Architect: Diego Tobal
Photo: Ivo Tavares Studio
Type: Private House



HYLINE.

MAKES THE

DIFFERENCE



HYLINE

18MM

Smallest central mullion in the world = 18 mm (patented).

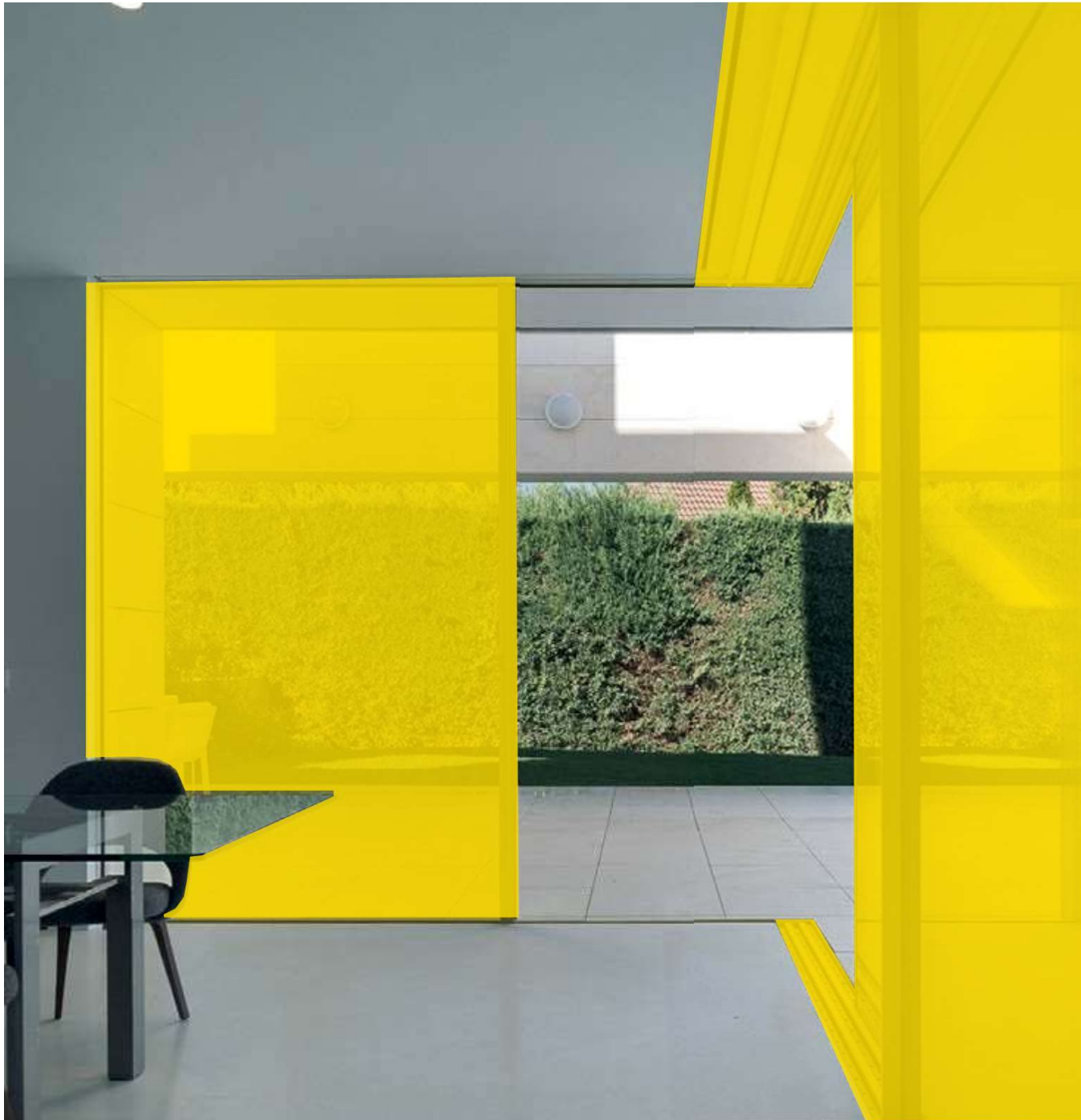

HYLINE

POCKET SYSTEM
&
CORNER SYSTEM

Window panels disappear into the pocket.
Openable corner window system.

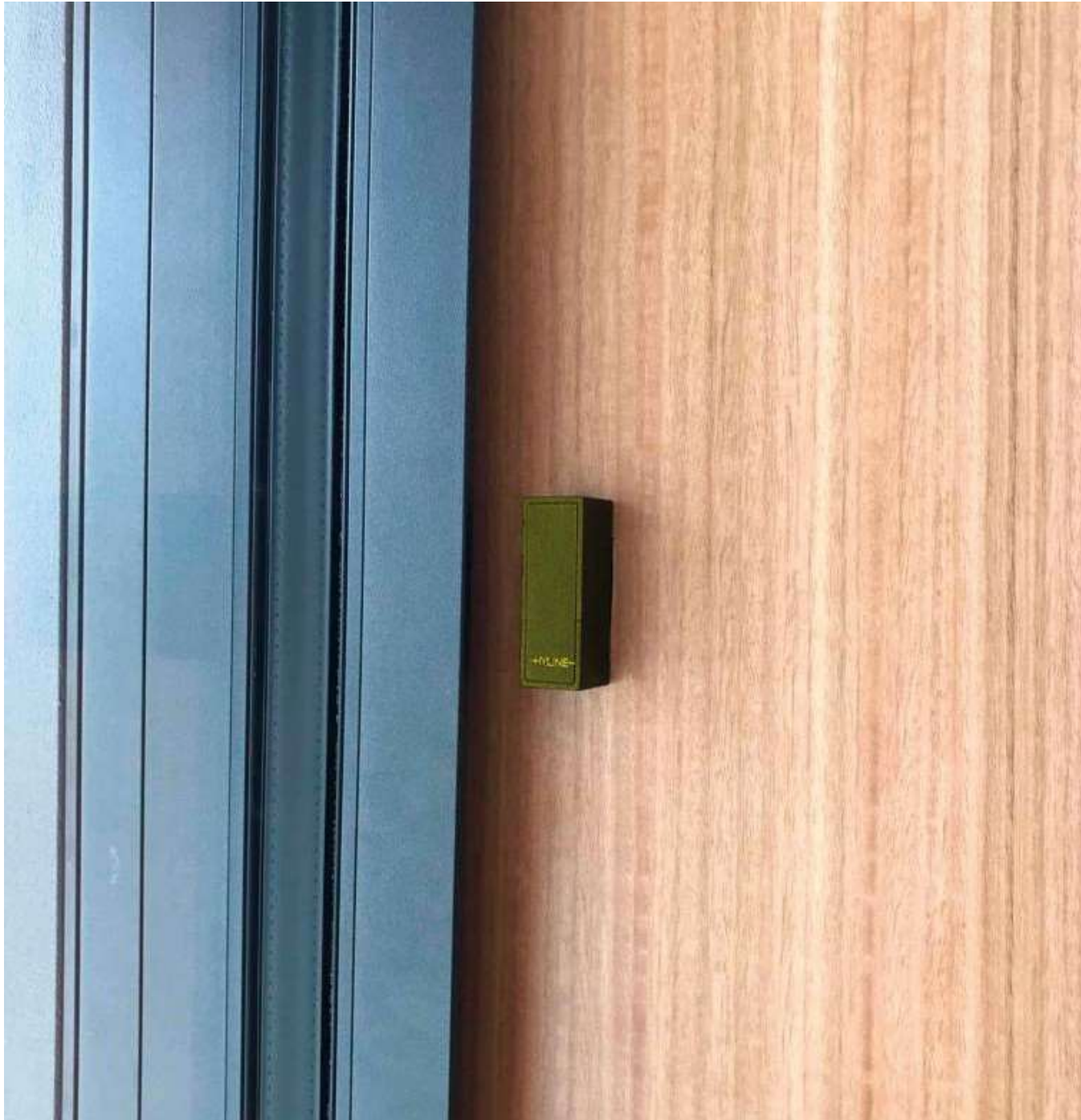

HYLINE

INTEGRATED LOCK

Integrated locks are one of many possibilities that HYLINE offers as an option to its customers. With the placement of our locks on the wall we achieve the perfect integration of the HYLINE system with the surrounding architecture, without losing reliability.



HYLINE

INVISIBLE FRAME

PERIMETRAL &

INTEGRATED FLOOR SYSTEM

The invisible frame system offers a completely hidden frame. Thanks to this, the indoor and outdoor relation is fully integrated and there are no obstacles in the floor, walls and ceilings. We also ensured that the existing gap in the sliding window is narrower than a lady's high heel, hides the bearings and avoids the accumulation of debris.

HYFLY

reddot award 2018
honourable mention

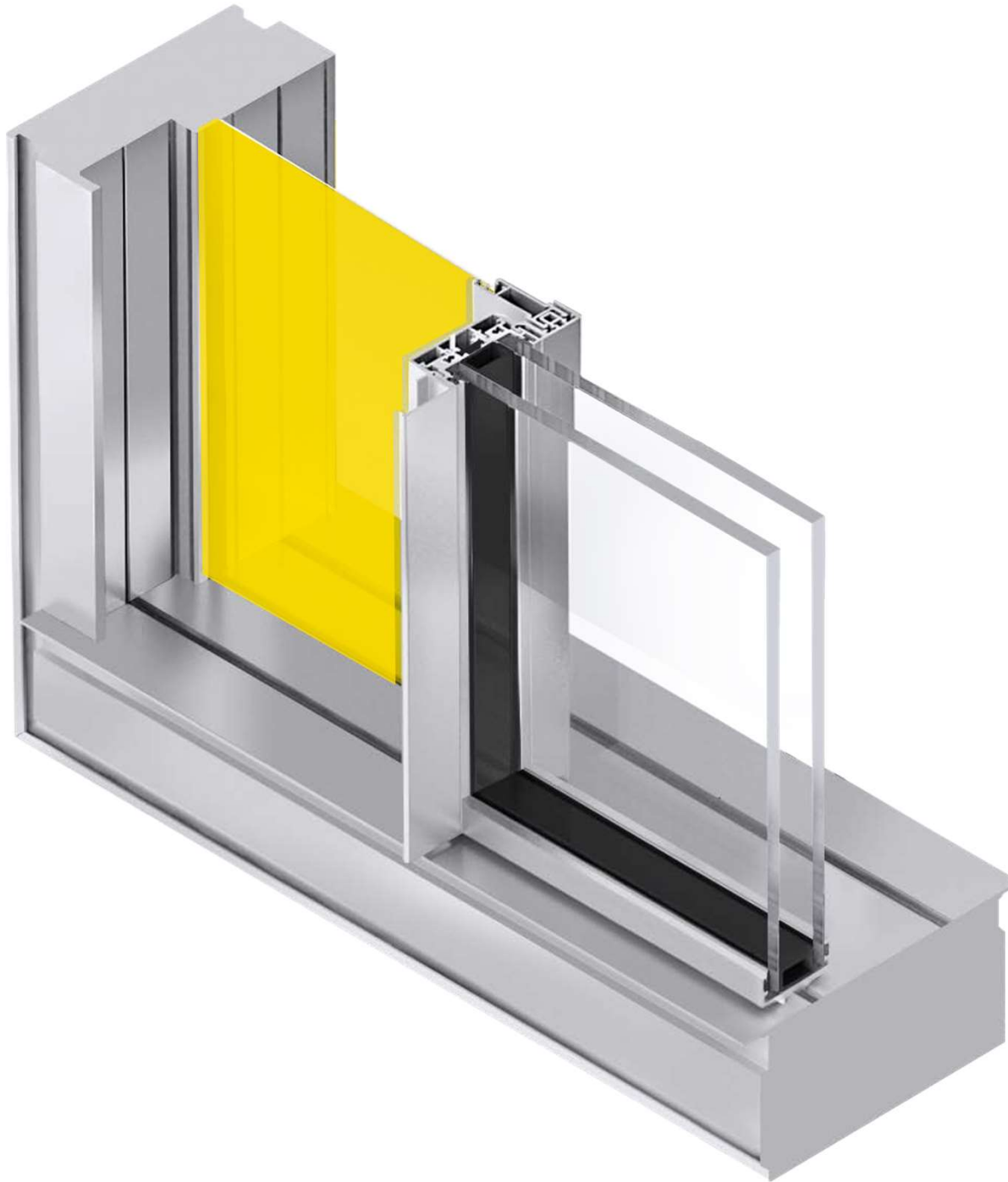

The fly screen system is a perfect, easy to use solution to naturally ventilate your home while being an effective protection against insects and pollen.

This manual or automatic system is fully integrated in the frame, only being visible when in use.

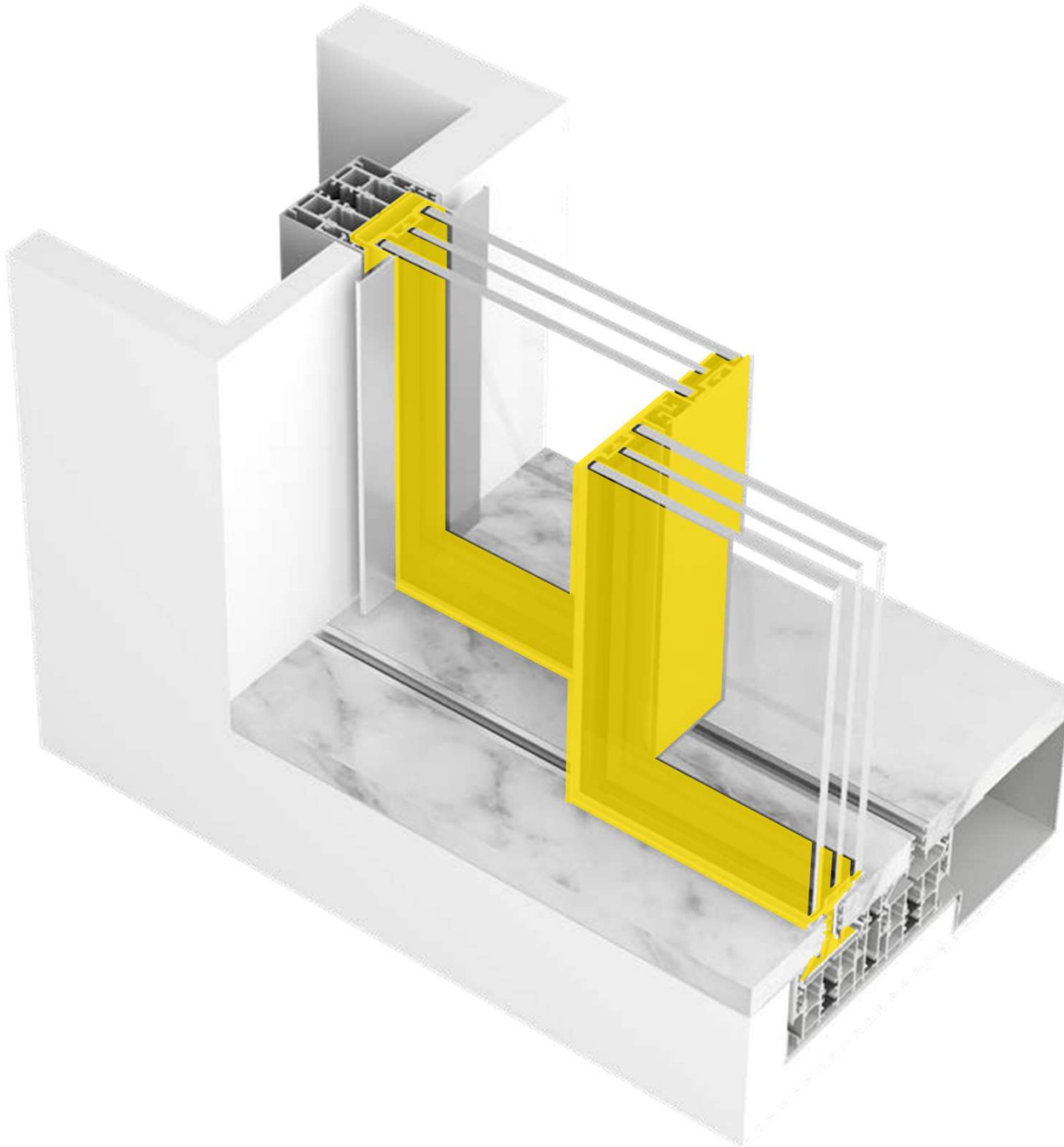

The HYINV system is characterized by the smallest aluminium view in the market of 1.8mm.

It assures the maximization of glazed areas without compromising robustness, comfort and safety.

SAFETY.

The HYLINÉ product range can be equipped with several types of safety equipment further than the traditional closing system. As an option we can install electromagnetic locks and an anti intrusion alarm sensor. All HYLINÉ windows are equipped with a multipoint locking system.



01

LOCK

HYLINE features a multipoint locking system. The mechanism is completely hidden in the frame and each locking point is adjustable.



02

INTEGRATED LOCK

You can integrate a key lock for better security and control. The cylinder lock is hidden on the wall for an invisible frame effect.

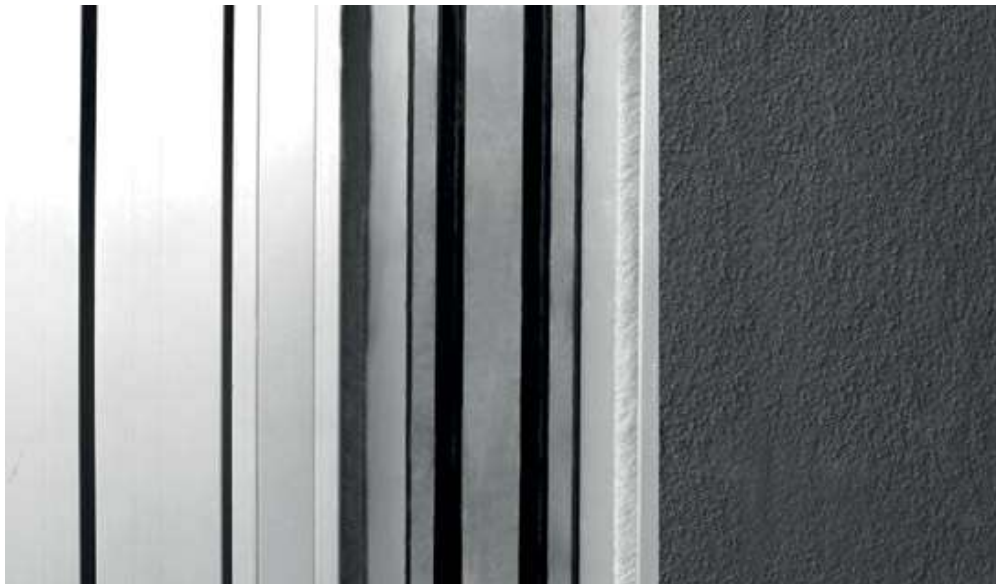

03

ELECTROMAGNETIC LOCK

You can integrate an electromagnetic lock for better security and control.



04 ALARM

Possibility of alarm cells and discrete integration on the profile



05 BURGLAR RESISTANCE CLASS

HYLINE locking systems have RC2 classification.



06

PERSONALIZED LOCKS

HYLINE has a fully customizable range of materials and finishings including gold, diamonds and carbon.



07

ANTI FALSE-MANEUVER SYSTEM

With the Anti False-Manoeuvre System you will never run the risk of getting closed from the outside.

SOPHISTICATED.

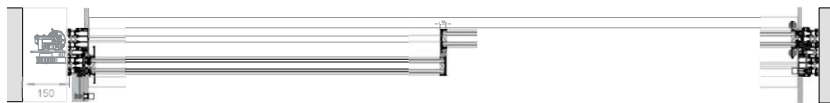
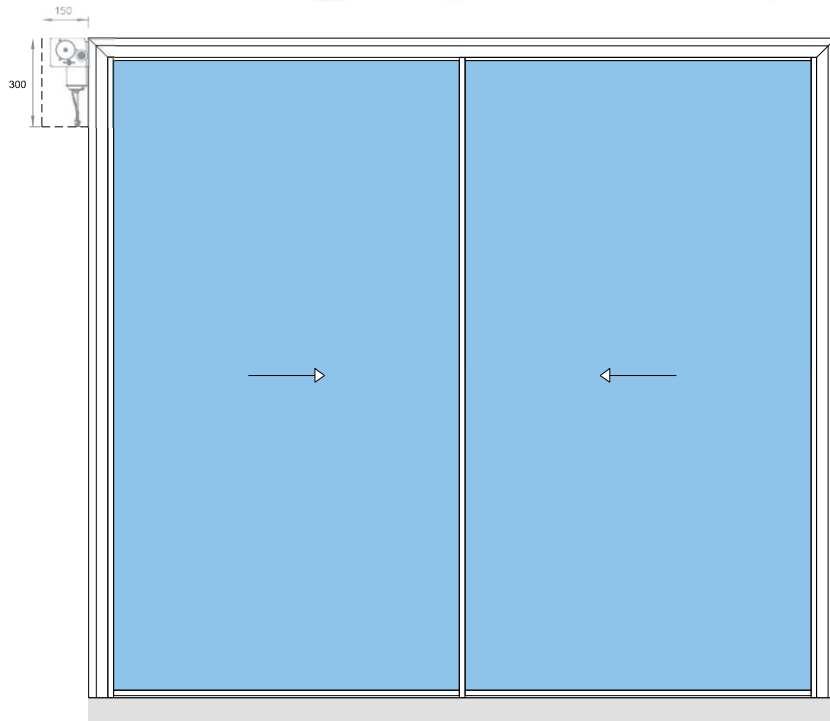

HORIZONTAL SECTION

01 HYMOTOR

The HYMOTOR system can be used in all of the sliding window configurations. In the case of power failure, all HYMOTOR systems can be manually operated.

Further customization possible according to clients' demands.



02

AUTO-STOP SYSTEM

In case of obstacle presence, the door automatically stops. (obstruction sensor).

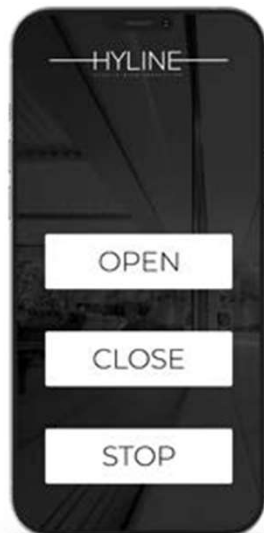

03

CONTROL SYSTEM

HYMOTOR is fully compatible with domotics systems and fully integrable with all automation systems. Customizable.



04

SLIDING SHUTTERS

In addition to glass, marble, wood, aluminium and flyscreen, panels are also available.



05

UNLIMITED RAILS

There is no limit to the number of rails and therefore vents. This allows tailor-made solutions for the most ambitious projects.



06

STAINLESS STEEL GUTTER

Our drainage system is fitted with a custom-made stainless steel gutter that improves water drainage, increases oxidation resistance and requires no maintenance.

COMFORT.



01

INTEGRATED SHUTTER SYSTEM

With HYLINE it is possible to have blackouts, screens, And blades integrated in the double glazing. Electrically operated and with no maintenance needed.

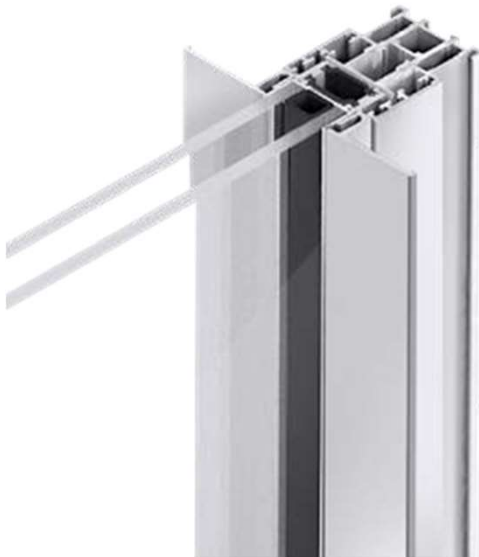

02

INTEGRATED HANDLE SYSTEM

We have the option of choosing different types of handles.



03

18MM PERIMETRAL

Non visible aluminum section.

SYSTEM

MAINTENANCE.



01

BEARINGS

Maintenance-free stainless steel bearings.



02

BEARINGS

The number of required bearings is calculated according to the width, height and weight of the vent. Our bearings were developed to withstand up to 200kg each and are sealed to improve durability.



03

CLEANING AND PRESERVATION

HYLINE has a cleaning kit which contains products suitable for aluminium maintenance. The kit includes: a cleaning and preservative spray, lubricant for hardware conservation, a vaseline applicator for gaskets conservation, a cleaning cloth and a Maintenance Manual with cleaning instructions and general information.





TECHNICAL DETAILS

PRIVATE HOUSE, GUIMARÃES, PORTUGAL.

ARCHITECT: REMA
PHOTO: IVO TAVARES STUDIO
TYPE: PRIVATE HOUSE

HYSLIM

SUITABLE FOR BUILDINGS IN WARM AND TROPICAL COUNTRIES

Best suited for tropical, hot climates and environments that do not require thermal and acoustic insulation, HYSLIM has been developed for monolithic glass. It joins lightness, finesse and design. With only a gentle push from the fingertips the window slides gently giving way to a total unity of interior and exterior. HYSLIM may be equipped with a fly screen.

1. Main Frame
2. Central Mullion
3. Glass
4. Drainage System
5. Inox Gutter
6. Interior Finish

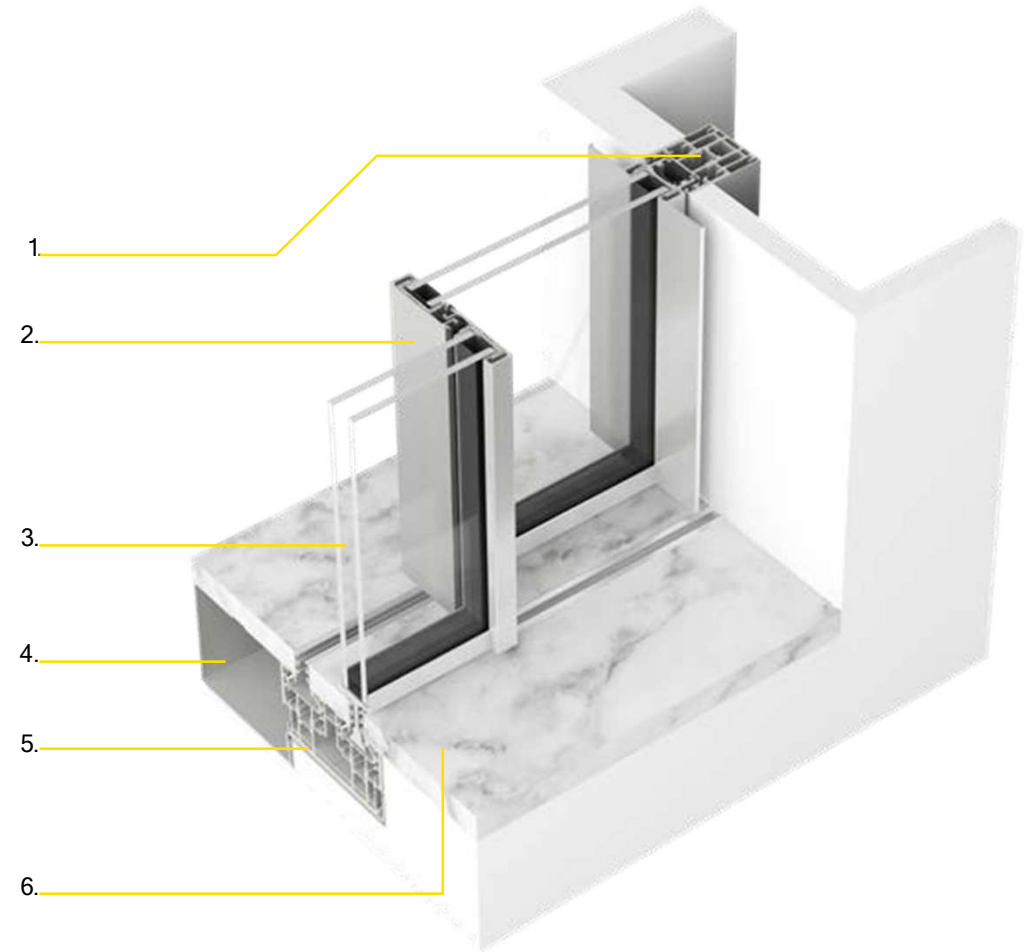

MEASUREMENTS

Maximum Width [CUSTOM]

Maximum Height 3500mm

Glazing (Maximum Area) 12m²

Maximum Weight 500Kg/ML

Opening Options Customized Corner

Maximum Box for Glass 10 to 28mm

Indicative Opening Types

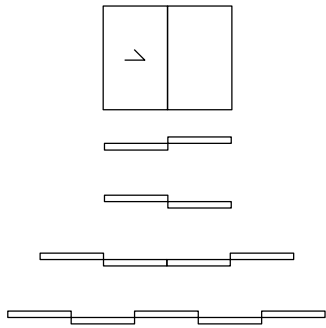

Bi-Rail

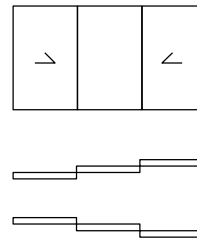

Tri-Rail

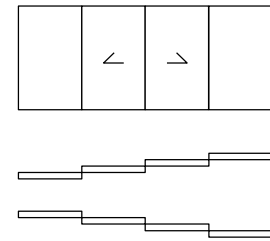

Quad-Rail

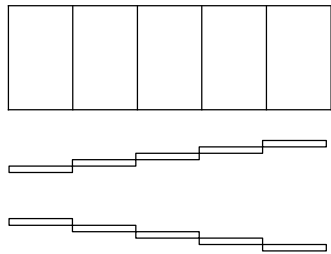

Penta-Rail

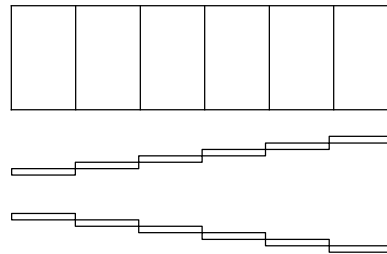

Hexa-Rail

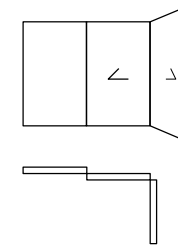

Corner

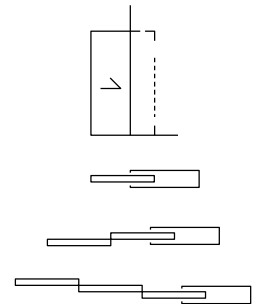

Pocket

SURFAC
TREATMENT

- HYLINE Colour Essentials (Ral Colores STD)
- HYLINE Natural Metals (Qualanod EURAS Class 2 STD)
- HYLINE Advanced Coating (Hiper Durable Finishings)
- HYLINE Luxury Collection under Qualicoat Seaside Standards

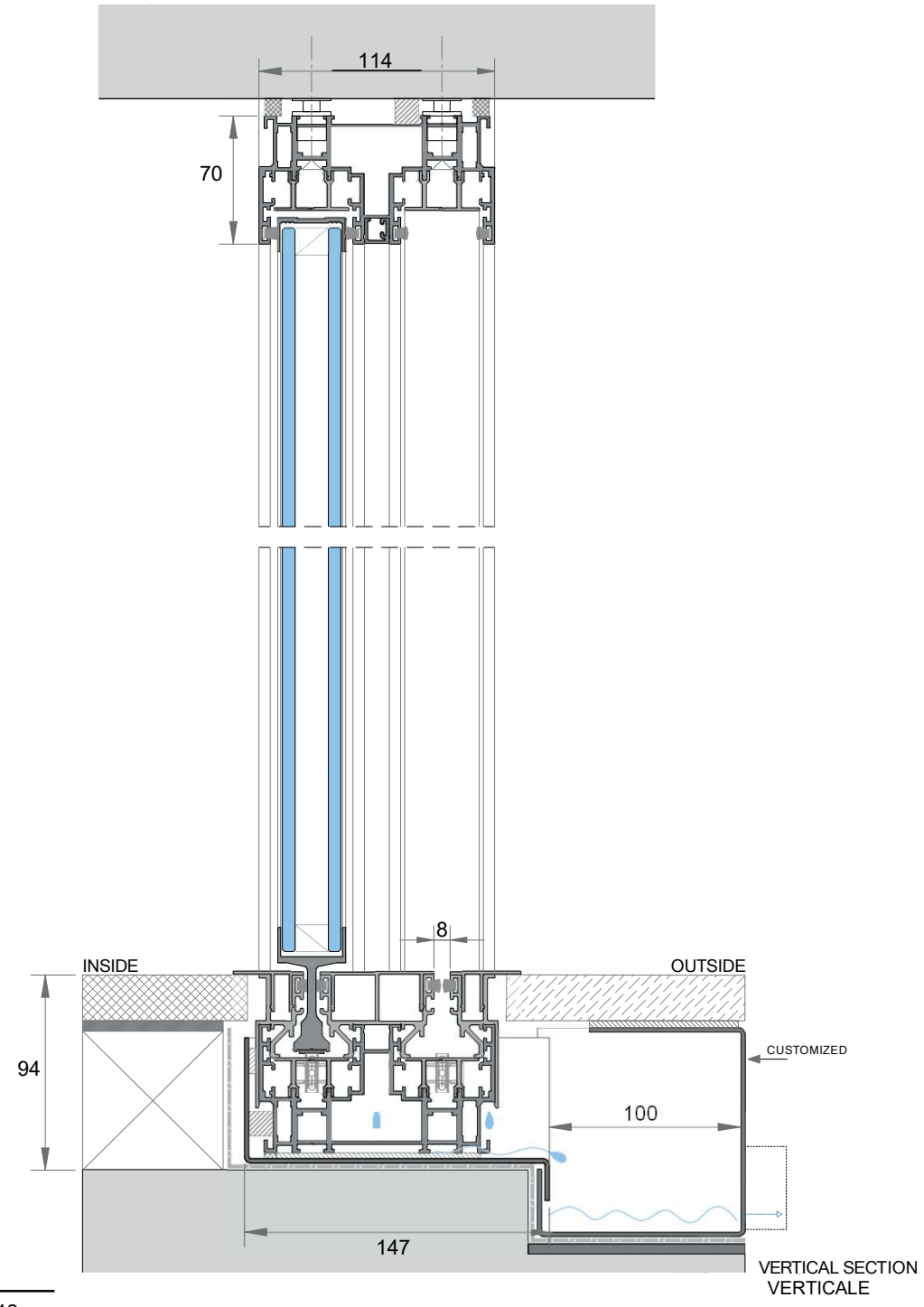

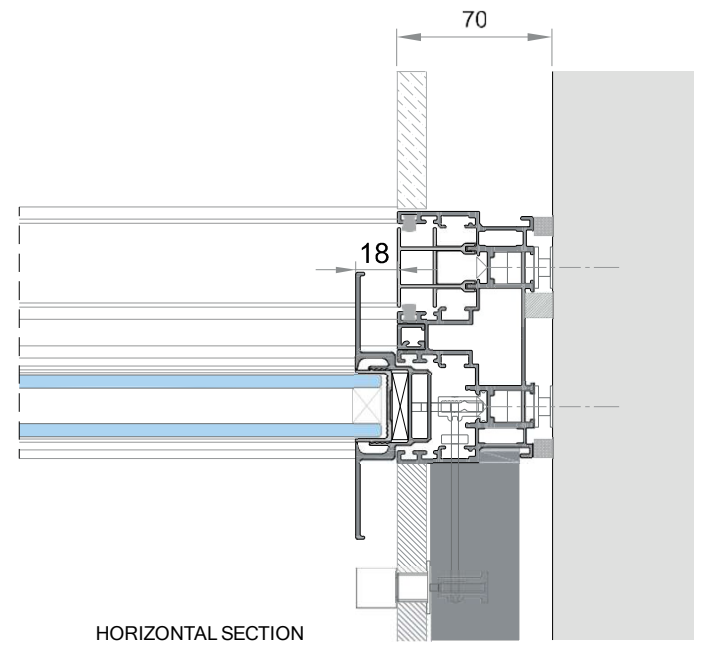
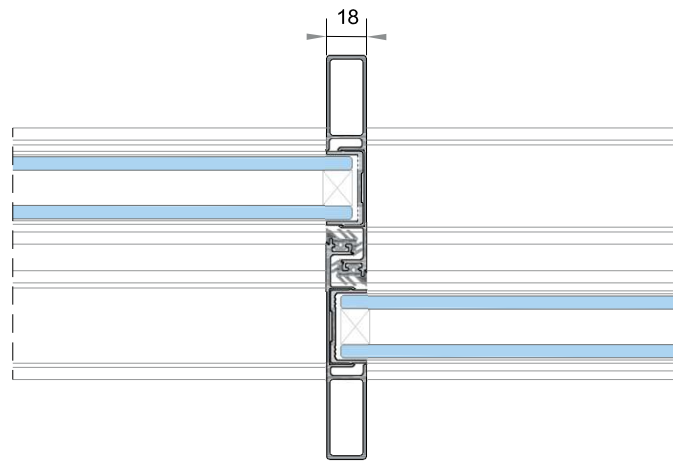
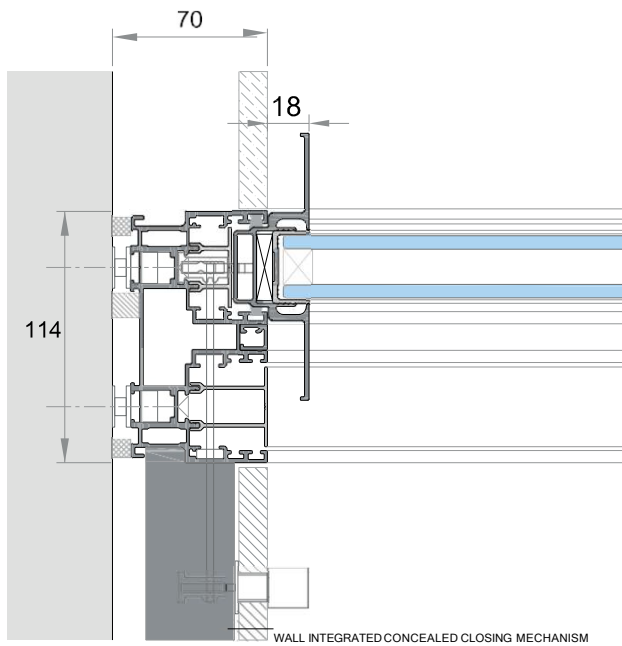

HY30

ONE SYSTEM,
SEVERAL POSSIBILITIES

This minimalist system is suited for premium jobs. It was developed to use double glass up to 28mm thickness, up to 3,5m height or a glass surface of up to 9m². This robust window offers excellent acoustic and thermal performance.

This system allows the inclusion of shutters and fly screens.

1. Main Frame
2. Central Mullion
3. Glass
4. Drainage System
5. Inox Gutter
6. Interior Finish

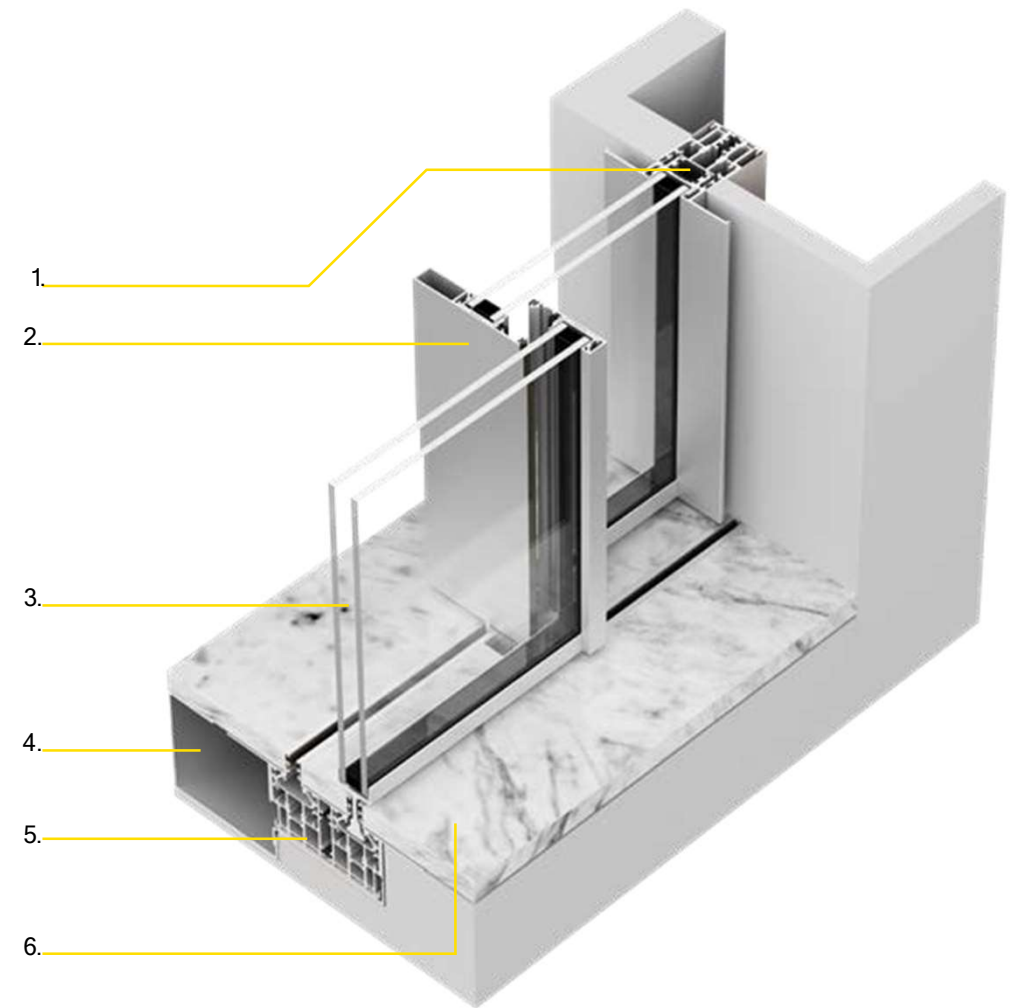

MEASUREMENTS

Maximum Width	[CUSTOM]	Maximum Weight	500Kg/ML	Maximum Box for Glass	28mm
Maximum Height	3500mm	Opening Options	Customized Corner Motorized		
Glazing (Maximum Area)	9m ²				

Indicative Opening Types

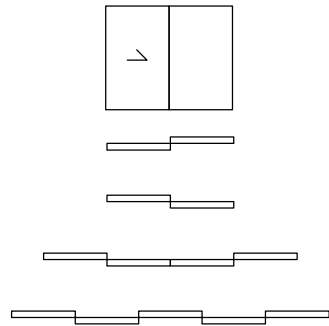

Bi-Rail

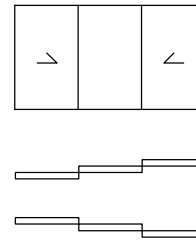

Tri-Rail

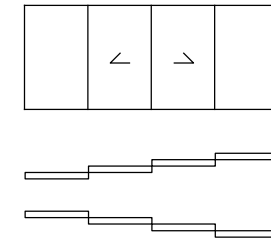

Quadri-Rail

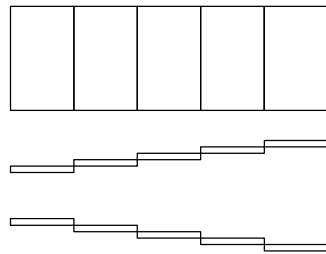

Penta-Rail

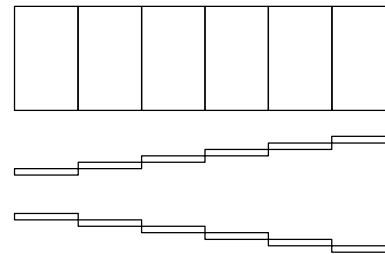

Hexa-Rail

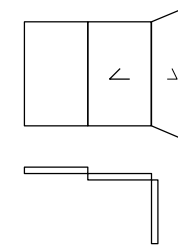

Corner

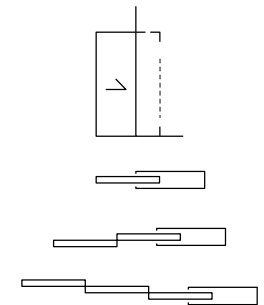

Pocket

SURFAC
TREATMENT

- HYLINE Colour Essentials (Ral Colores STD)
- HYLINE Natural Metals (Qualanod EURAS Class 2 STD)
- HYLINE Advanced Coating (Hiper Durable Finishings)
- HYLINE Luxury Collection under Qualicoat Seaside Standards

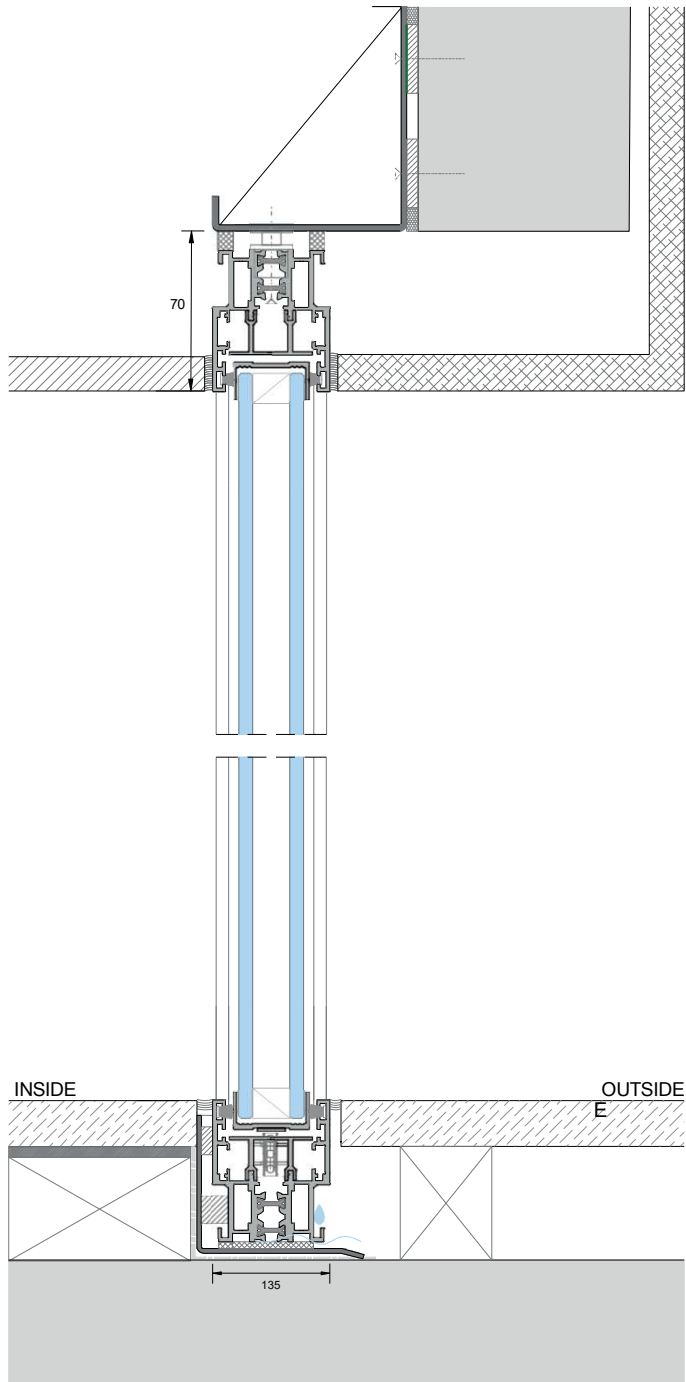

VERTICAL SECTION
VERTICALE

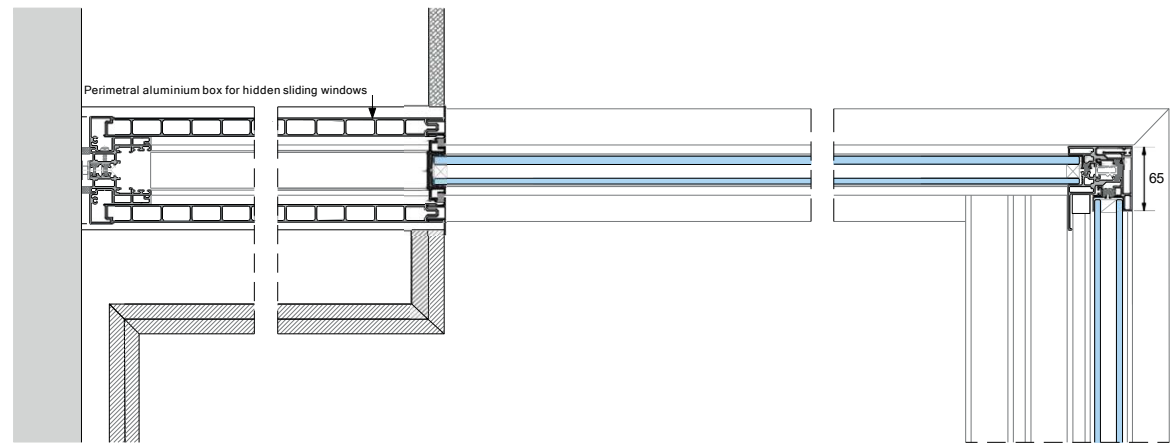

HORIZONTAL SECTION

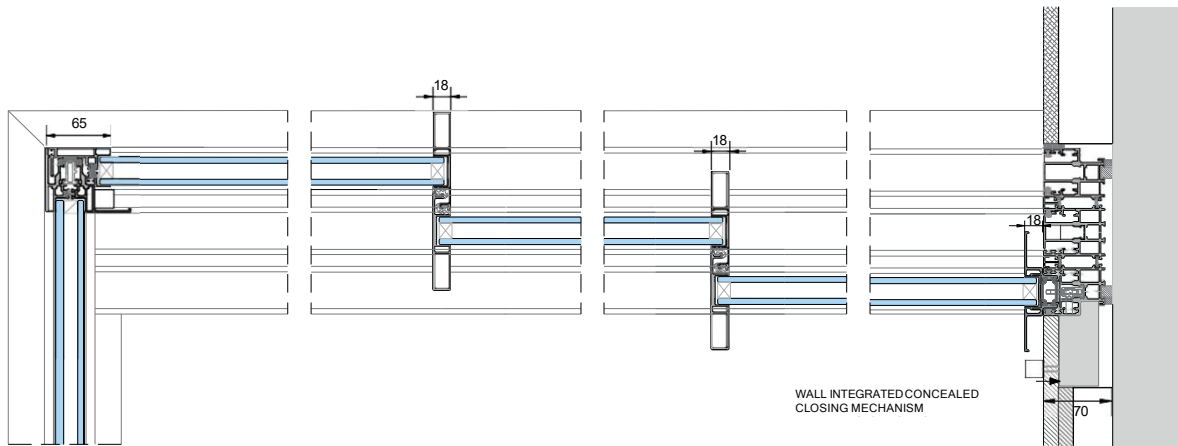

WALL INTEGRATED CONCEALED
CLOSING MECHANISM

HORIZONTAL SECTION

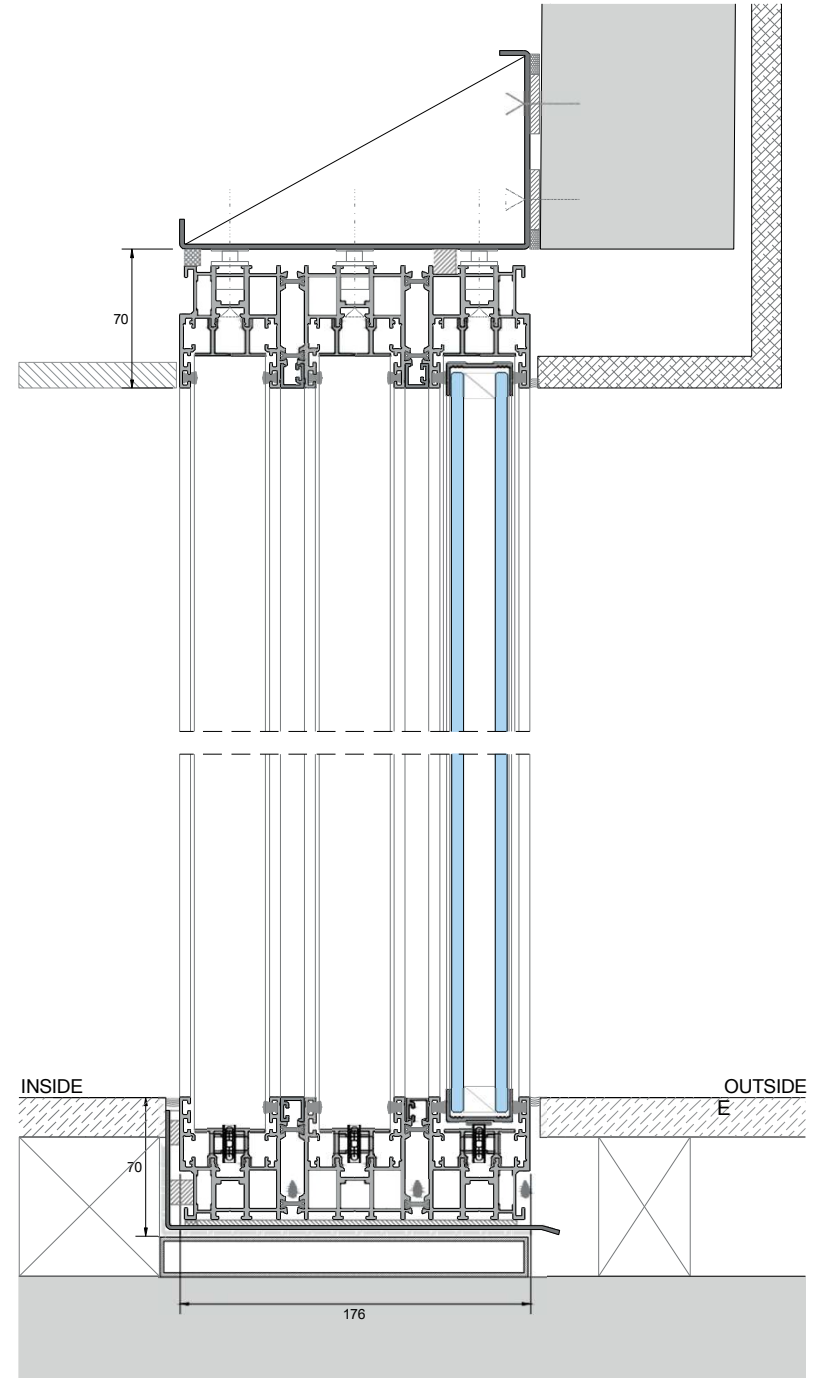

VERTICAL SECTION
VERTICALE

HY40

pat. #2853674

IDEAL FOR EVERY SITUATION

This minimalist system is suited for premium jobs. It was developed to use double glass up to 38mm thickness, up to 6m height or a glass surface of up to 28m². This robust window offers excellent acoustic and thermal performance. Developed with sophistication and attention to design in mind, this system is characterized by the smallest central mullion in the market and an integrated floor option that fully hides the frame, resulting in a obstacle-free threshold.

This system allows the inclusion of blackouts, blinds, screen in the interior glass and fly screens.

1. Main Frame
2. Central Mullion
3. Glass
4. Drainage System
5. Inox Gutter
6. Interior Finish

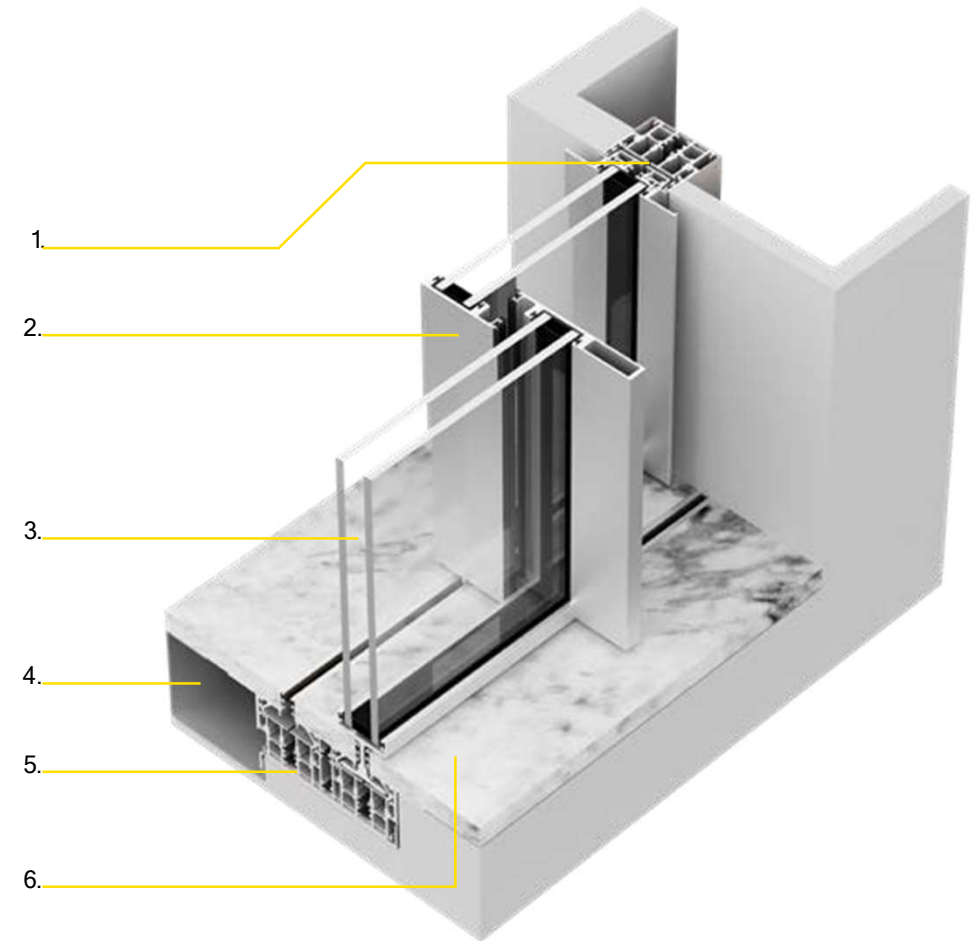

MEASUREMENTS

Maximum Width	[CUSTOM]	Maximum Weight	1000Kg/ML	Maximum Box for Glass	38mm
Maximum Height	6000mm	Opening Options	Customized Corner Motorized		
Glazing (Maximum Area)	18m ²				

Indicative Opening Types

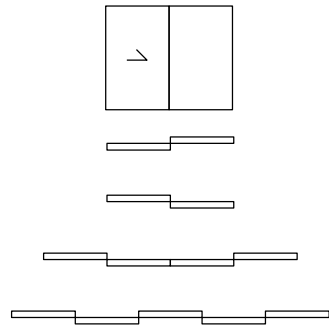

Bi-Rail

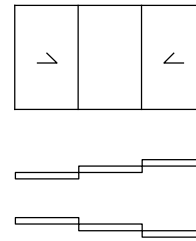

Tri-Rail

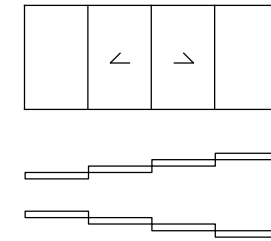

Quadri-Rail

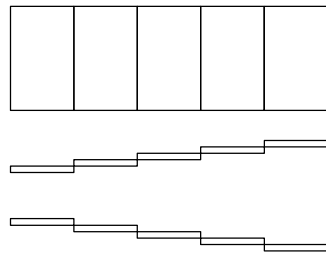

Penta-Rail

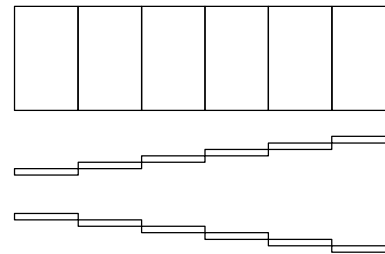

Hexa-Rail

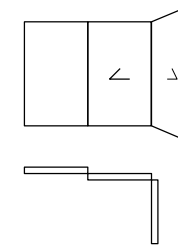

Corner

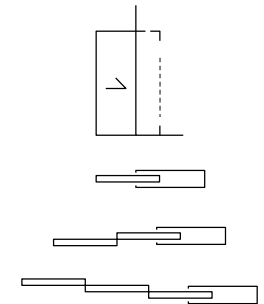

Pocket

SURFAC
TREATMENT

- HYLINE Colour Essentials (Ral Colores STD)
- HYLINE Natural Metals (Qualanod EURAS Class 2 STD)
- HYLINE Advanced Coating (Hiper Durable Finishings)
- HYLINE Luxury Collection under Qualicoat Seaside Standards

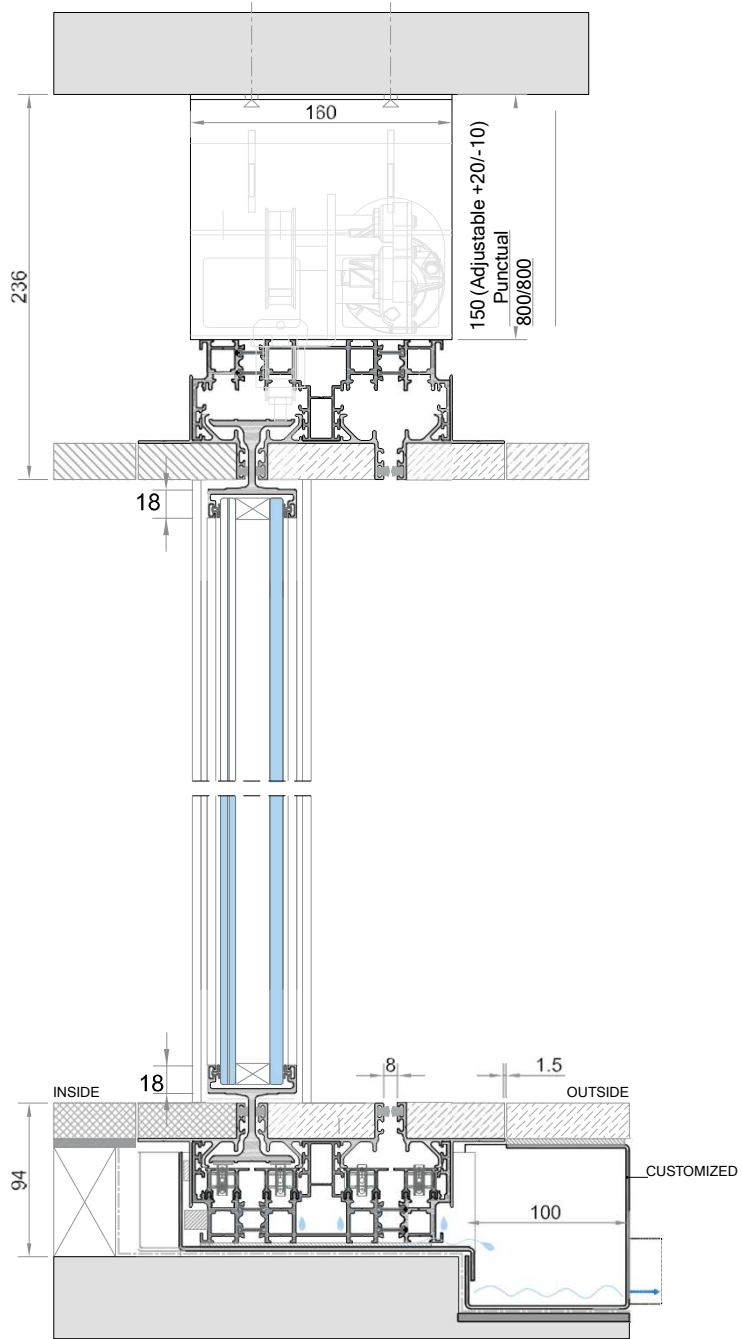

VERTICAL SECTION

Perimetral aluminium box for hidden sliding windows

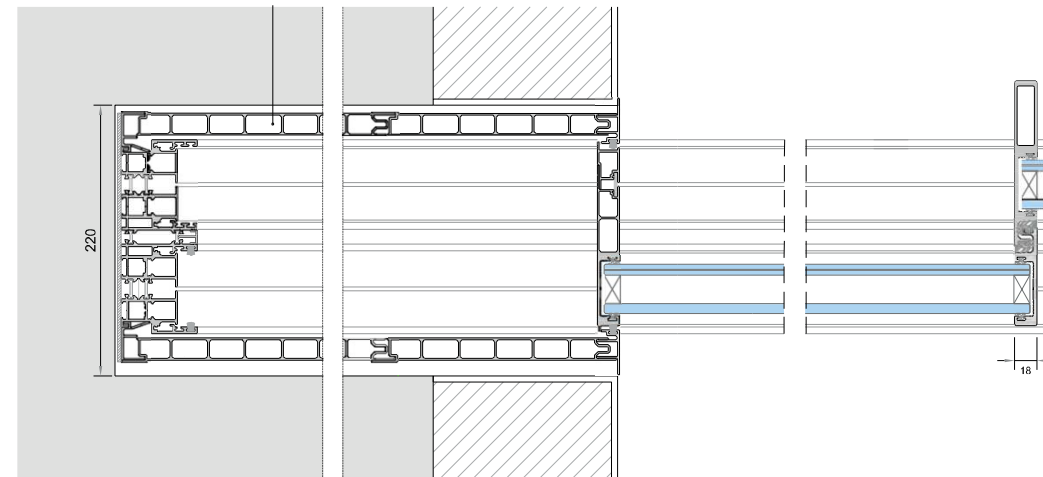

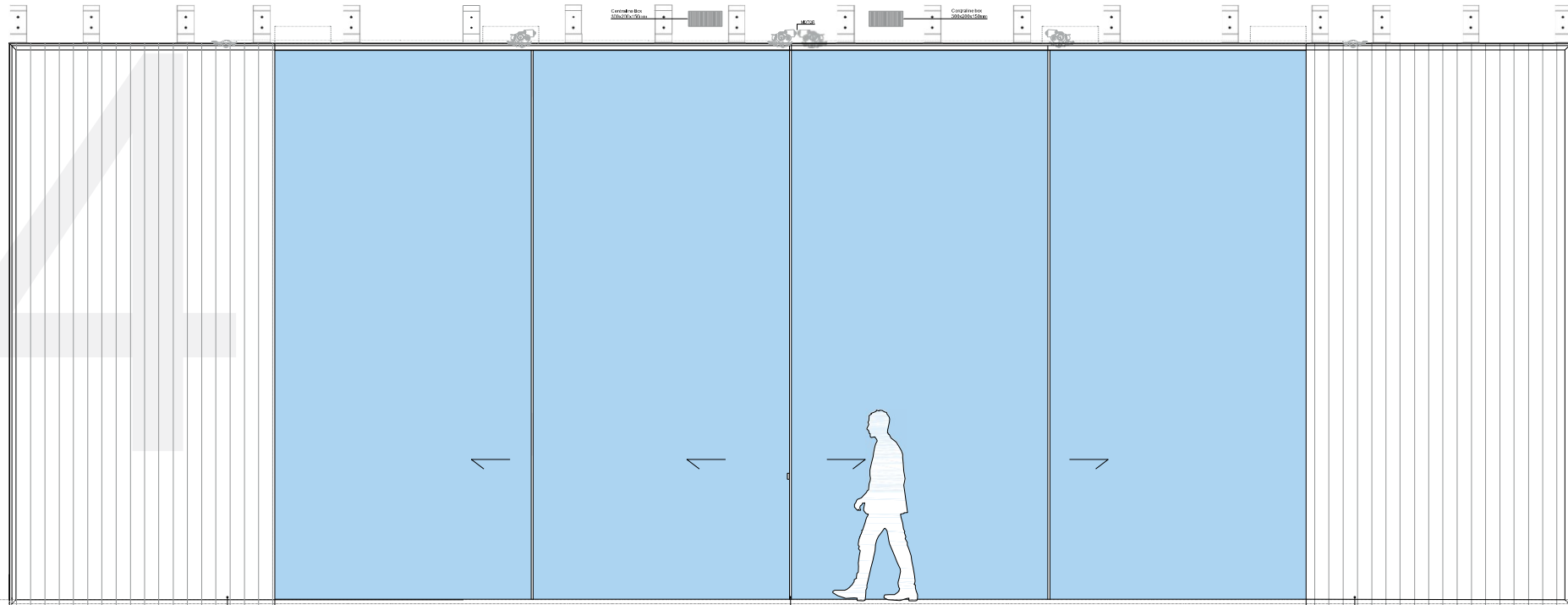

Perimetral aluminium box for hidden sliding windows

Even with an 18mm view, it will be possible having a multipoint closure with three closing points

Perimetral aluminium box for hidden sliding windows

INTERIOR VIEW

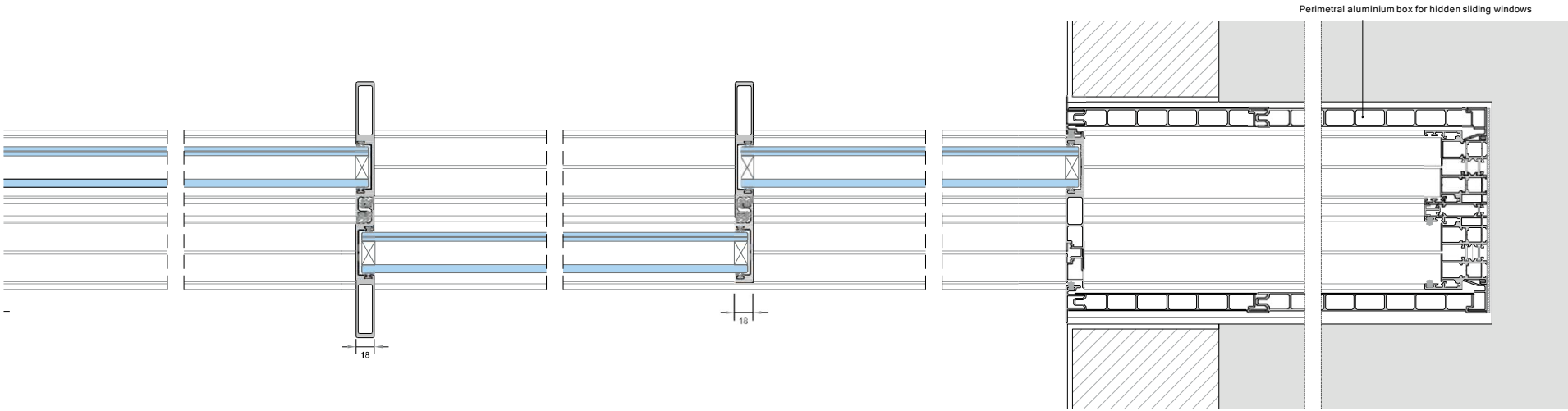

Perimetral aluminium box for hidden sliding windows

HORIZONTAL SECTION

HY50

THE ULTIMATE MINIMALIST SYSTEM

1. Main Frame
2. Central Mullion
3. Glass
4. Drainage System
5. Inox Gutter
6. Interior Finish

This minimalist system is suited for jobs that require extreme performances. It was developed to use double or triple glass up to 48mm thickness, up to 6m height or a glass surface of up to 28m². This robust window offers the best acoustic and thermal performance. Developed with sophistication and attention to design in mind, this system is characterized by the smallest central mullion in the market and an integrated floor option that fully hides the frame, resulting in a obstacle-free threshold.

This system allows the inclusion of blackouts, blinds, screen in the interior glass and fly screens.

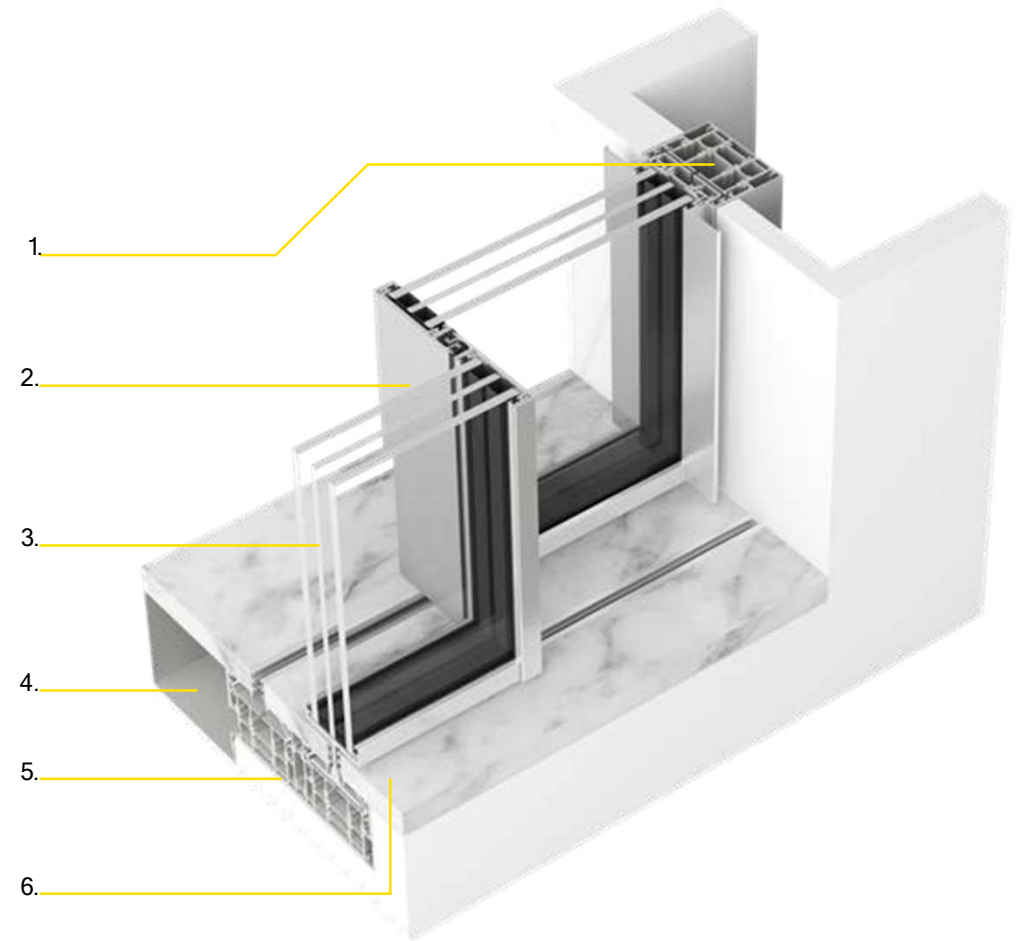

MEASUREMENTS

Maximum Width	[CUSTOM]	Maximum Weight	1000Kg/ML	Maximum Box for Glass	48mm
Maximum Height	6000mm	Opening Options	Customized Automatic Motorized		
Glazing (Maximum Area)	18m ²				

Indicative Opening Types

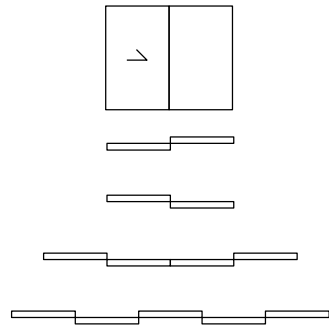

Bi-Rail

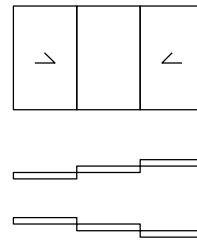

Tri-Rail

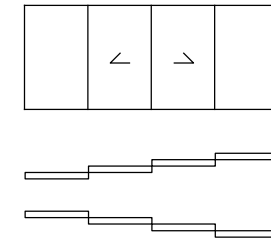

Quadri-Rail

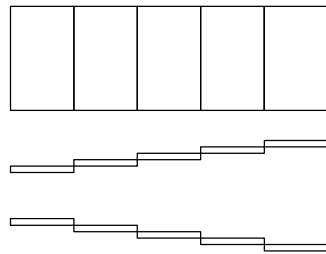

Penta-Rail

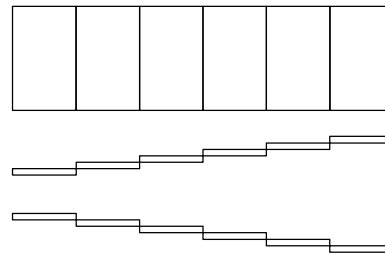

Hexa-Rail

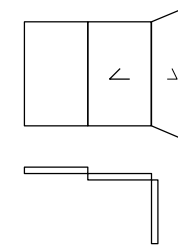

Corner

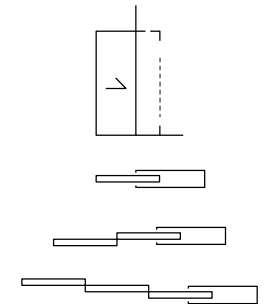

Pocket

SURFAC
TREATMENT

- HYLINE Colour Essentials (Ral Colores STD)
- HYLINE Natural Metals (Qualanod EURAS Class 2 STD)
- HYLINE Advanced Coating (Hiper Durable Finishings)
- HYLINE Luxury Collection under Qualicoat Seaside Standards

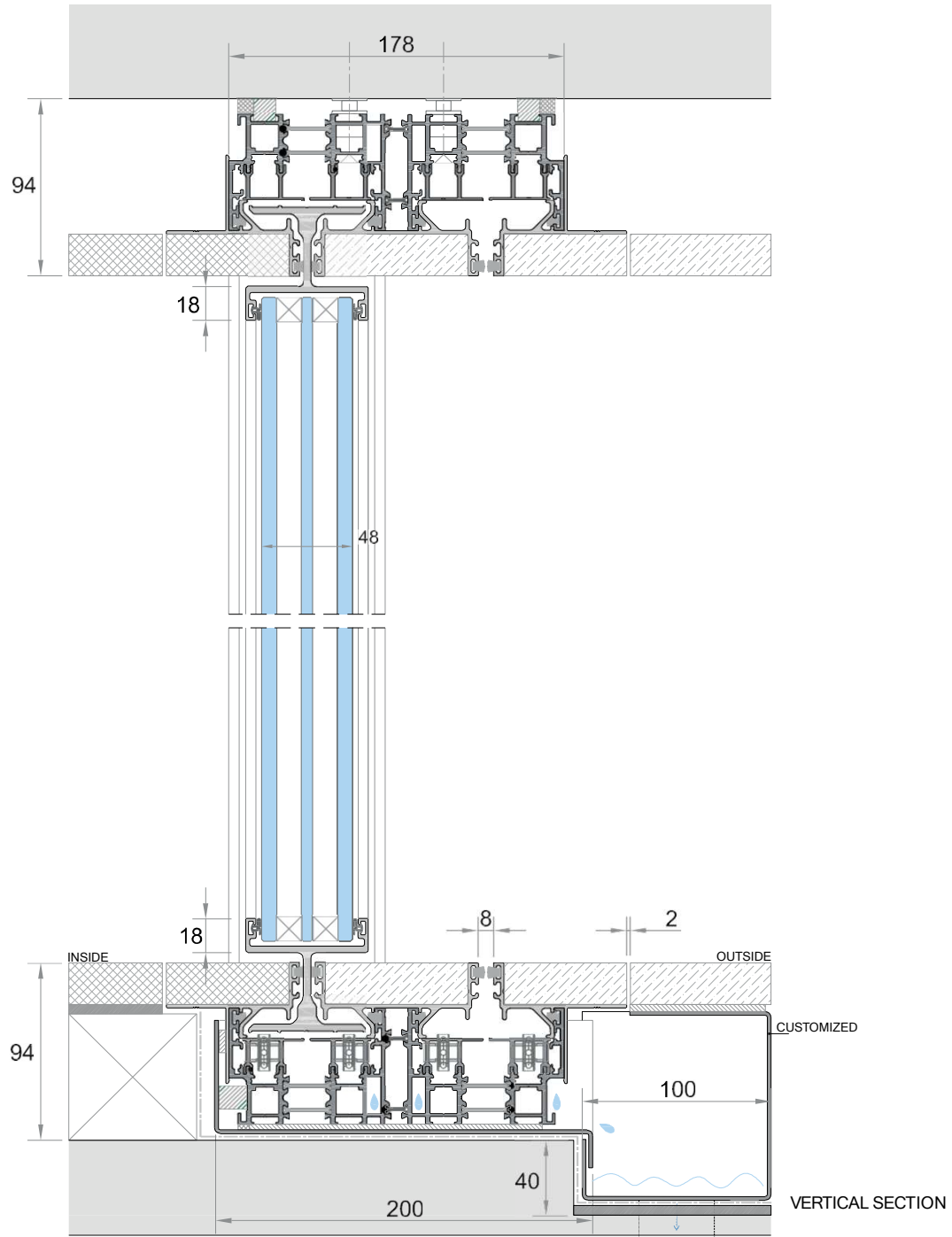

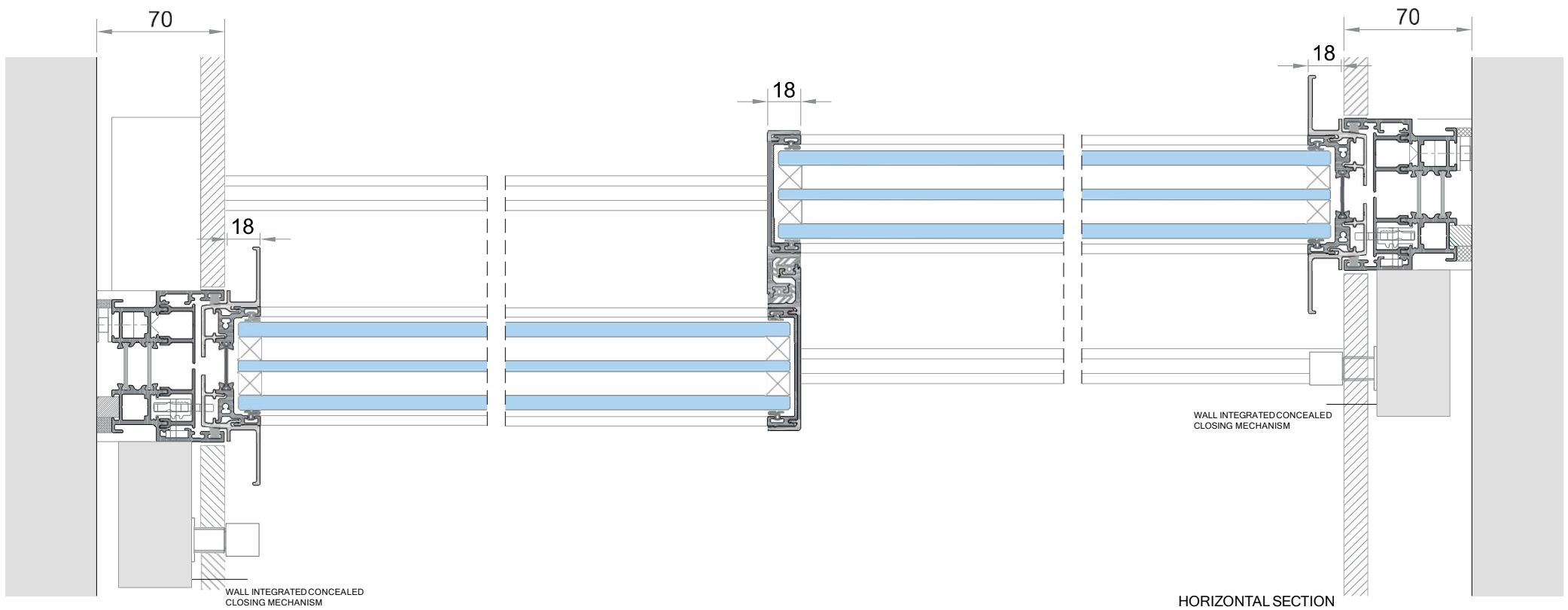

HYPI

DETAILS MAKE A DIFFERENCE

This system was specially developed to fulfill the needs of modern architecture. It is suitable for large entrance doors while maintaining the same minimalist design language that defines HYLINE. Despite the large dimensions of the vents it ensures a silent and effort free utilization. The hardware used in the HYPI system is fully hidden, allowing for a perfect framing of the surrounding landscape.

Further customization is possible according to client demands. After all, in HYLINE details make the difference.

- Includes:
- Perimetral multipoint closures possibility;
 - Double perimetral seal;
 - Automatic operation available

Also available as HYPIWOOD, a version with wood finishing.

1. Main Frame
2. Mullion
3. Glass
4. Interior Finish

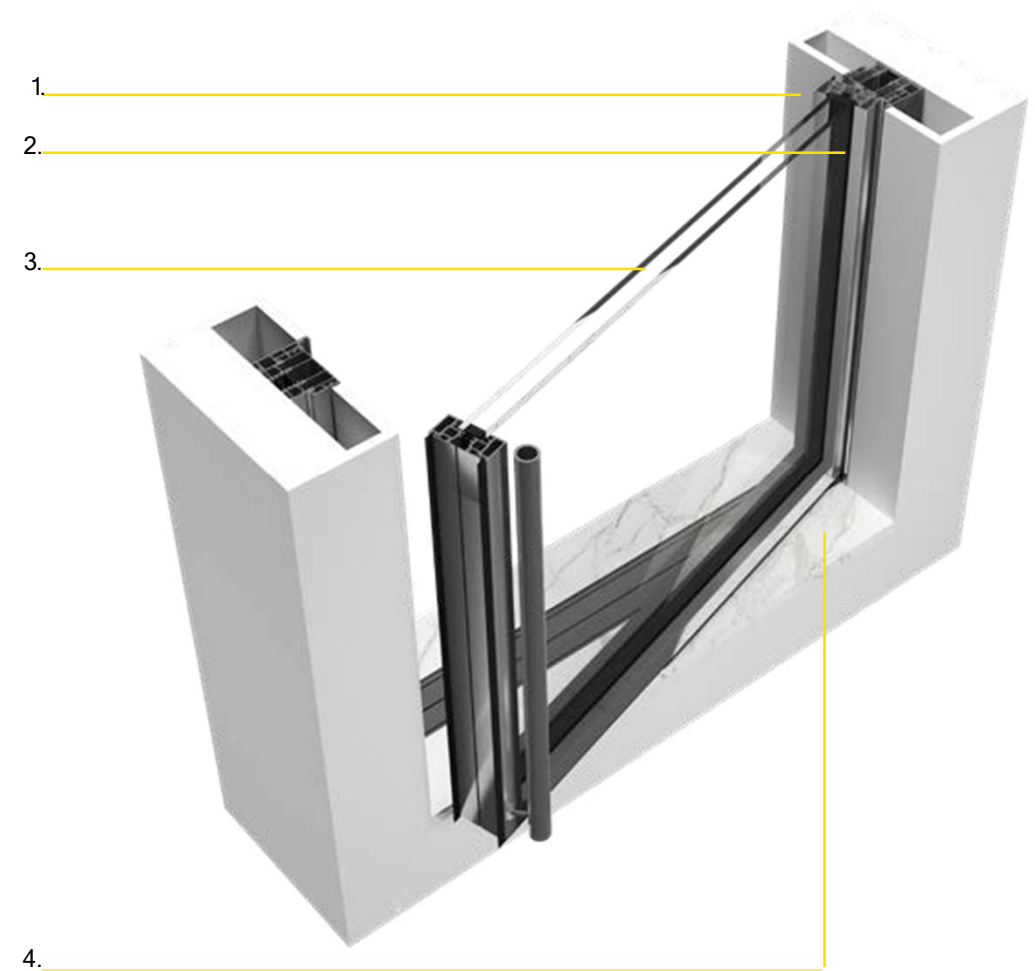

MEASUREMENTS

Maximum Width	2500mm
Maximum Height	5000mm
Glazing (Maximum Area)	Under consultation

Maximum Weight	750Kg PER VENT
Opening Options	Manual Motorized

Maximum Box for Glass	38mm
-----------------------	------

Indicative Opening Types

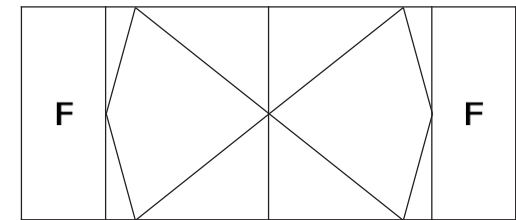
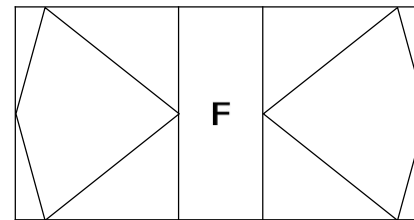
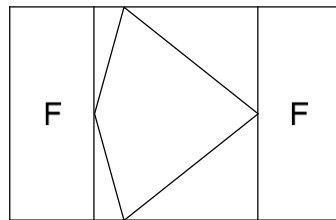
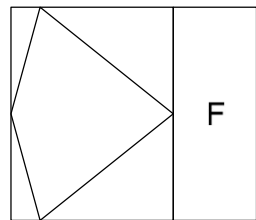
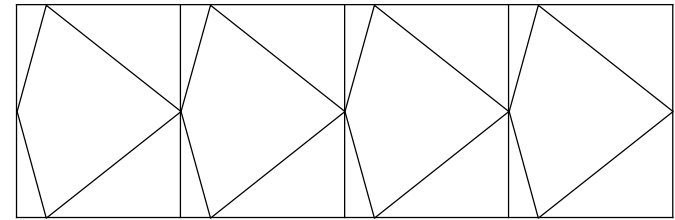
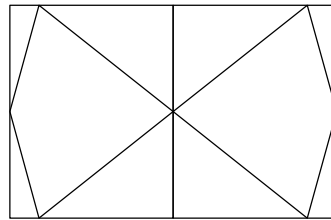
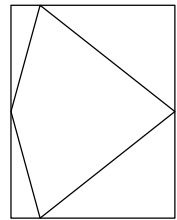

SURFAC
TREATMENT

- HYLINE Colour Essentials (Ral Colores STD)
- HYLINE Natural Metals (Qualanod EURAS Class 2 STD)
- HYLINE Advanced Coating (Hiper Durable Finishings)
- HYLINE Luxury Collection under Qualicoat Seaside Standards

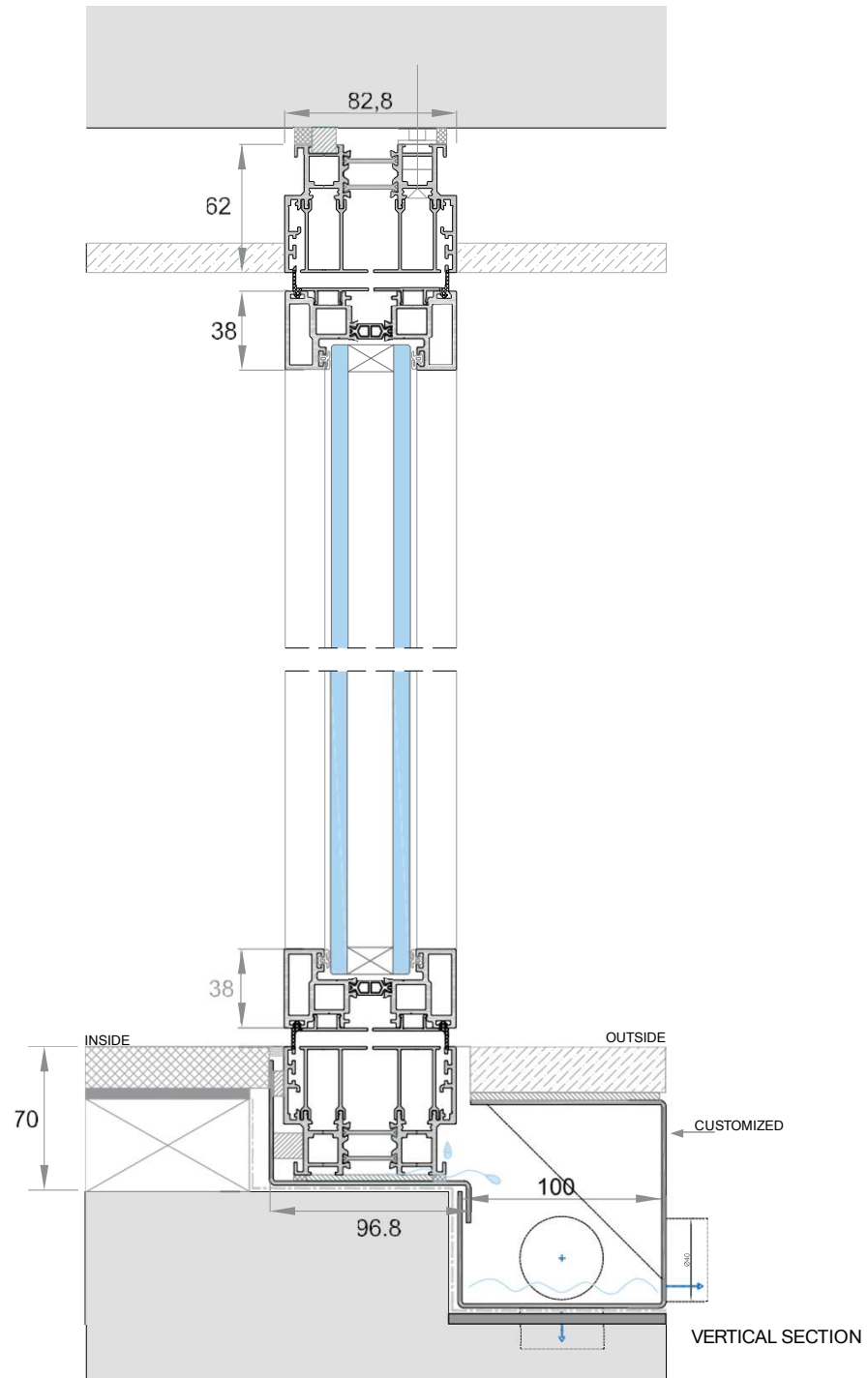

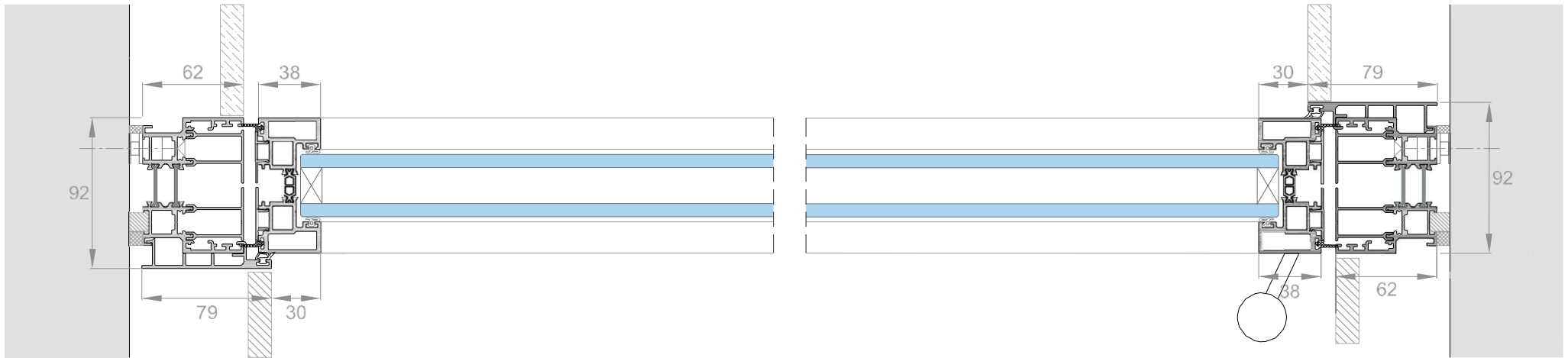

HORIZONTAL SECTION

HYGUI

INDOOR AND OUTDOOR PASSAGES

The guillotine system is one of the innovated lines and luxury designs of the High Tec performances, as the other series from HYLINE. It offers total openings in great dimensions. HYGUI has a vertical closing and opening movement without any barrier. The sash, perfectly balanced (maximum up to 340kg for each sash), can manually be operated without effort. Motorization can be an option. With an adjusted natural ventilation, and fully vertical openings, HYLINE has added new solutions. HYGUI glazing can range up to 6m wide and 3m high weighing up to 3500kg, which also can be automatically retracted offering new and huge perspectives.

1. Main Frame
2. Central Mullion
3. Glass
4. Inox Gutter
5. Interior Finish

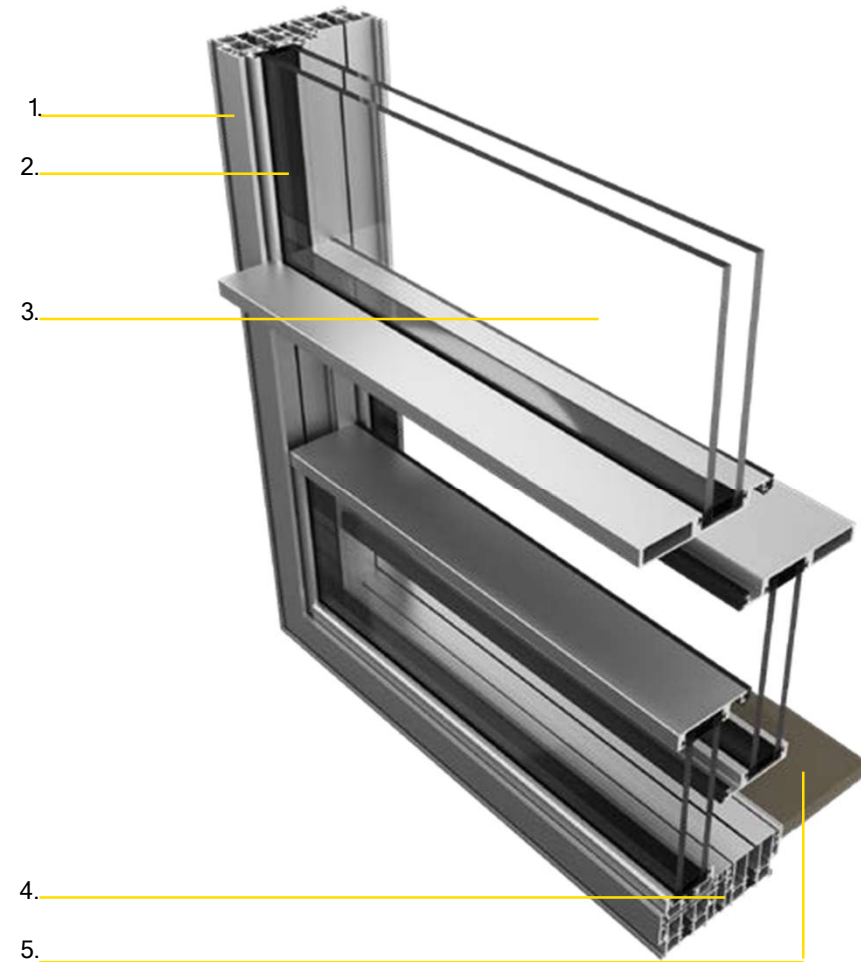

MEASUREMENTS

Maximum Width	Under consultation	Maximum Weight	340Kg PER VENT 3.500Kg PER VENT FOR MOTORIZED OPERATION	Maximum Box for Glass	28mm
Maximum Height	Under consultation	Opening Options	Vertical opening, with or without pocket		38mm
Glazing (Maximum Area)	Under consultation				

Indicative Opening Types

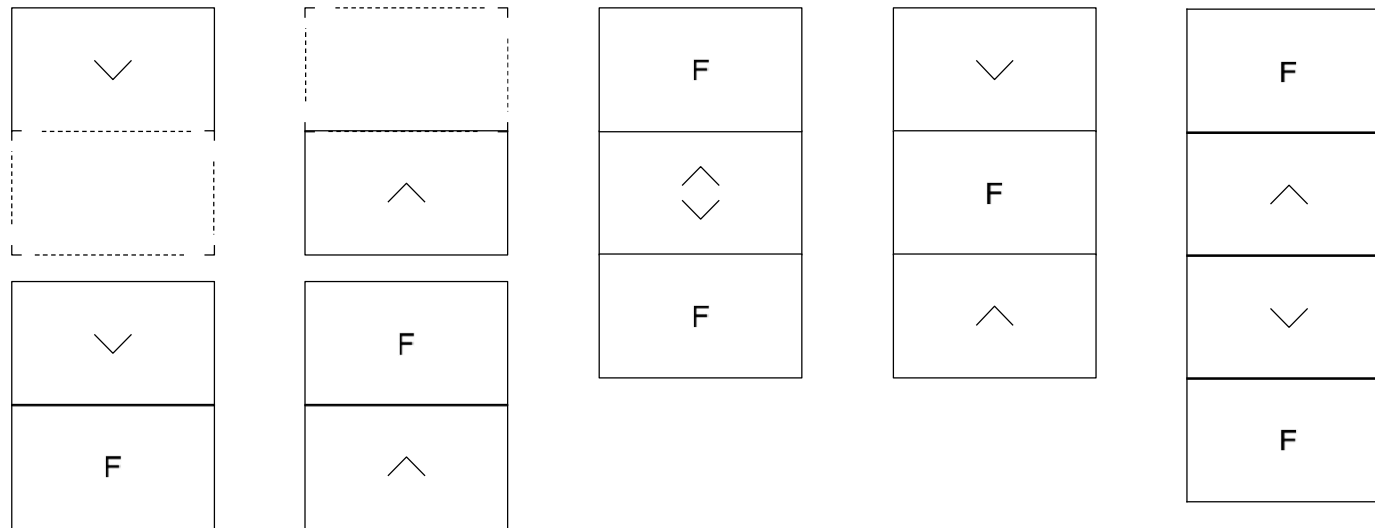

SURFAC
TREATMENT

- HYLINE Colour Essentials (Ral Colores STD)
- HYLINE Natural Metals (Qualanod EURAS Class 2 STD)
- HYLINE Advanced Coating (Hiper Durable Finishings)
- HYLINE Luxury Collection under Qualicoat Seaside Standards

Typologies under consultation

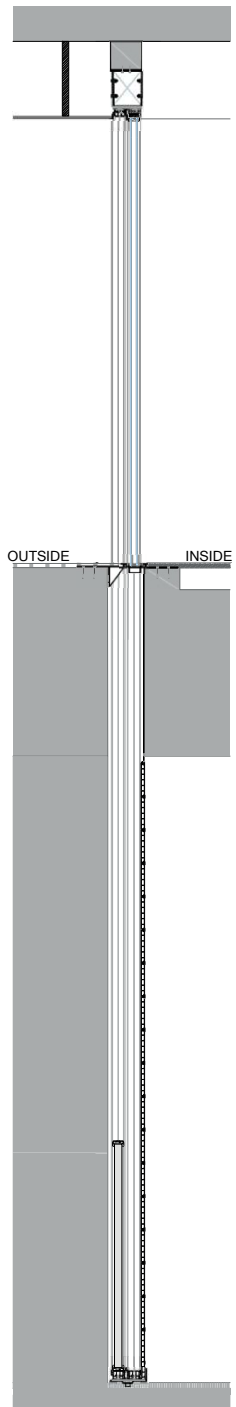

VERTICAL SECTION

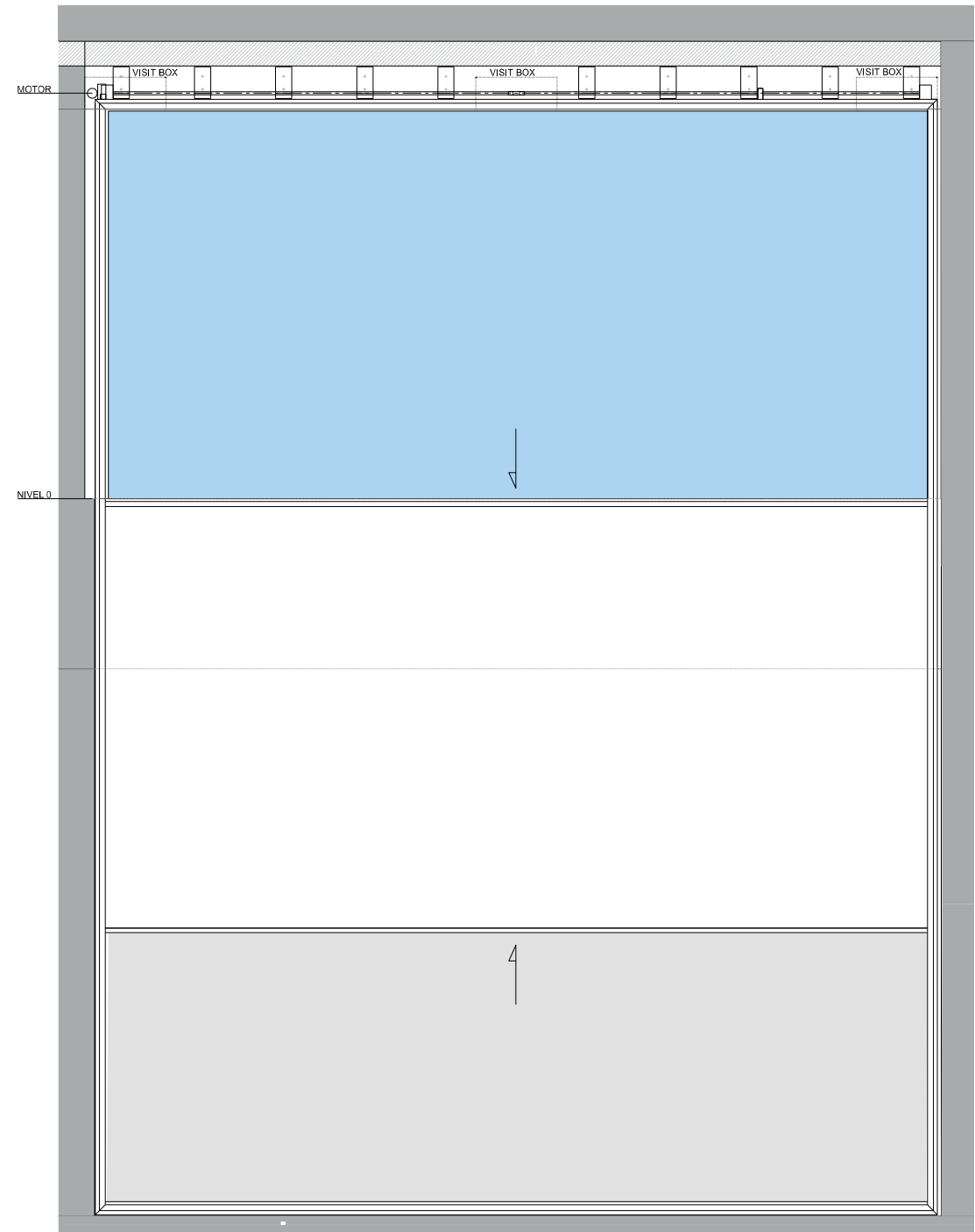

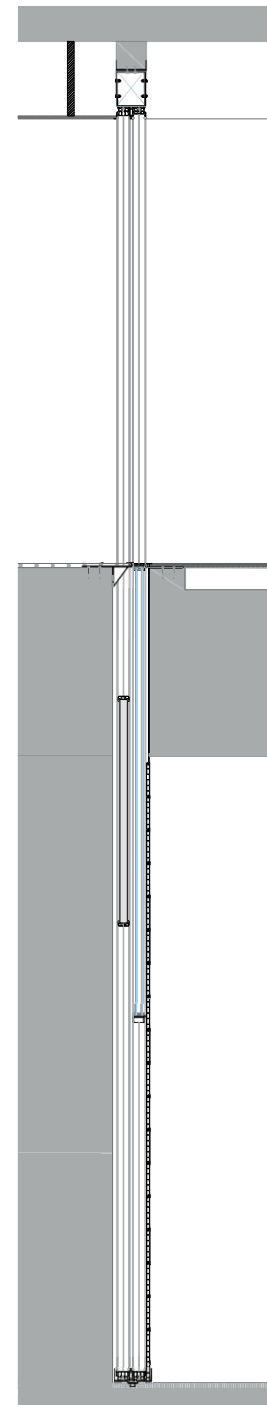
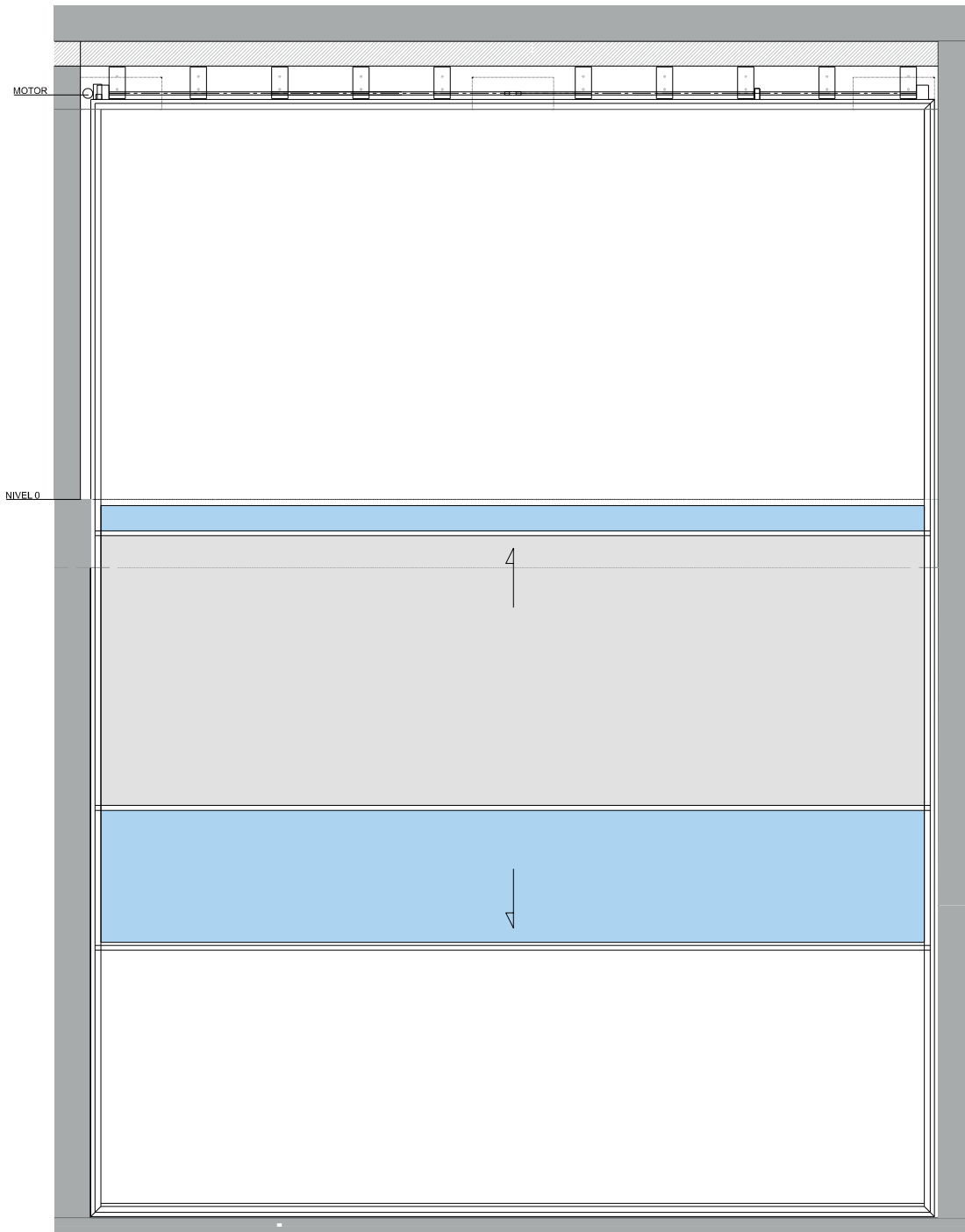

VERTICAL SECTION

HYARC

SOFTNESS IN THE CONTOURS

APPLICABLE FOR HYSLIM
AND HY30/40/50 MODELS

An innovative HYLIME sliding system, ideal for those looking for the opposite of the linearity found in traditional architecture. With excellent thermal and acoustic performance, curved glass panels allow you to open a number of options in contemporary architecture. It is possible to soften the contours of a room without losing the HYLIME identity, as well as to revolutionize the façade, opening an infinite world of customizations with organic forms.

1. Main Frame
2. Central Mullion
3. Glass
4. Drainage System
5. Inox Gutter
6. Interior Finish

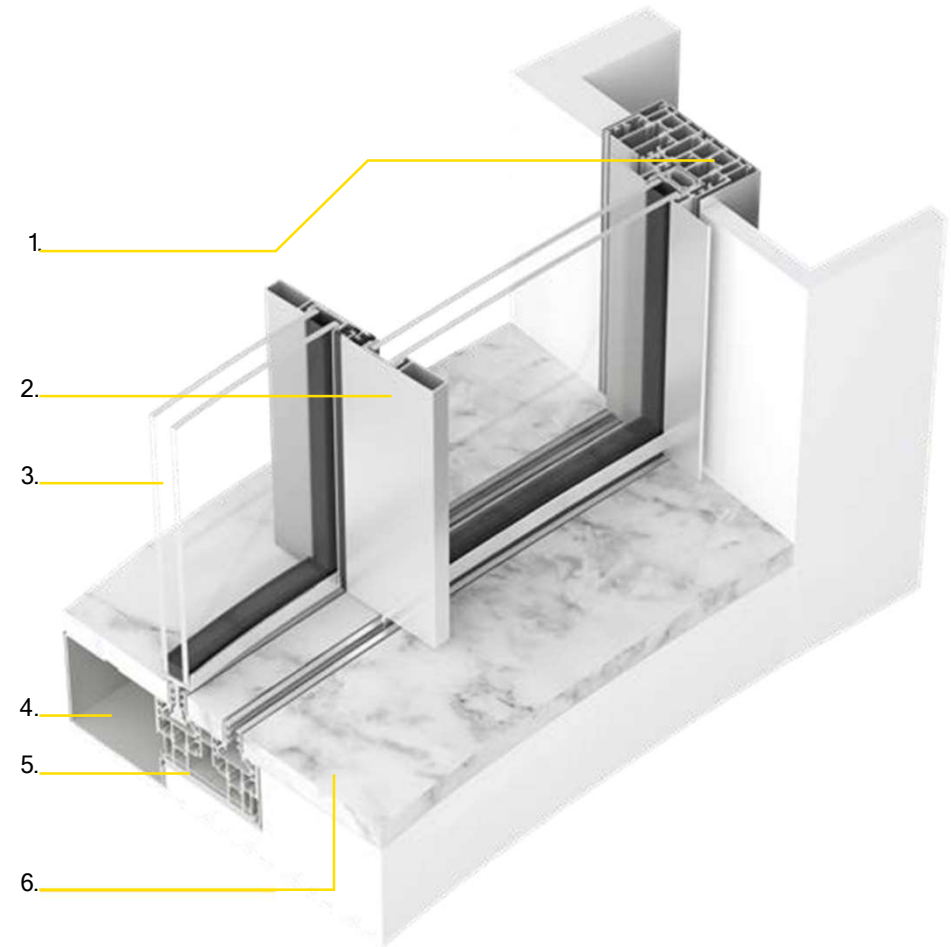

MEASUREMENTS

Maximum Width	Under consultation	Maximum Weight	1000Kg/ML	Maximum Box for Glass	48mm
Maximum Height	3500mm	Opening Options	Under consultation		
Glazing (Maximum Area)	10m ² > UNDER CONSULTATION		Under consultation		

Indicative Opening Types

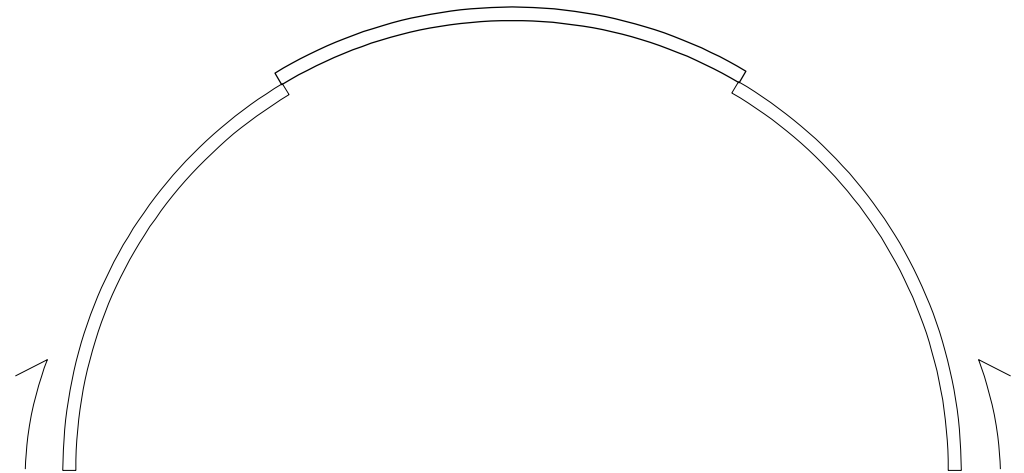
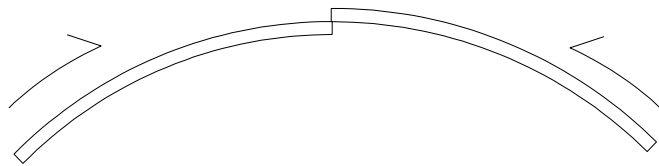

Bi-Rail

SURFAC
TREATMENT

- HYLINE Colour Essentials (Ral Colores STD)
- HYLINE Natural Metals (Qualanod EURAS Class 2 STD)
- HYLINE Advanced Coating (Hiper Durable Finishings)
- HYLINE Luxury Collection under Qualicoat Seaside Standards

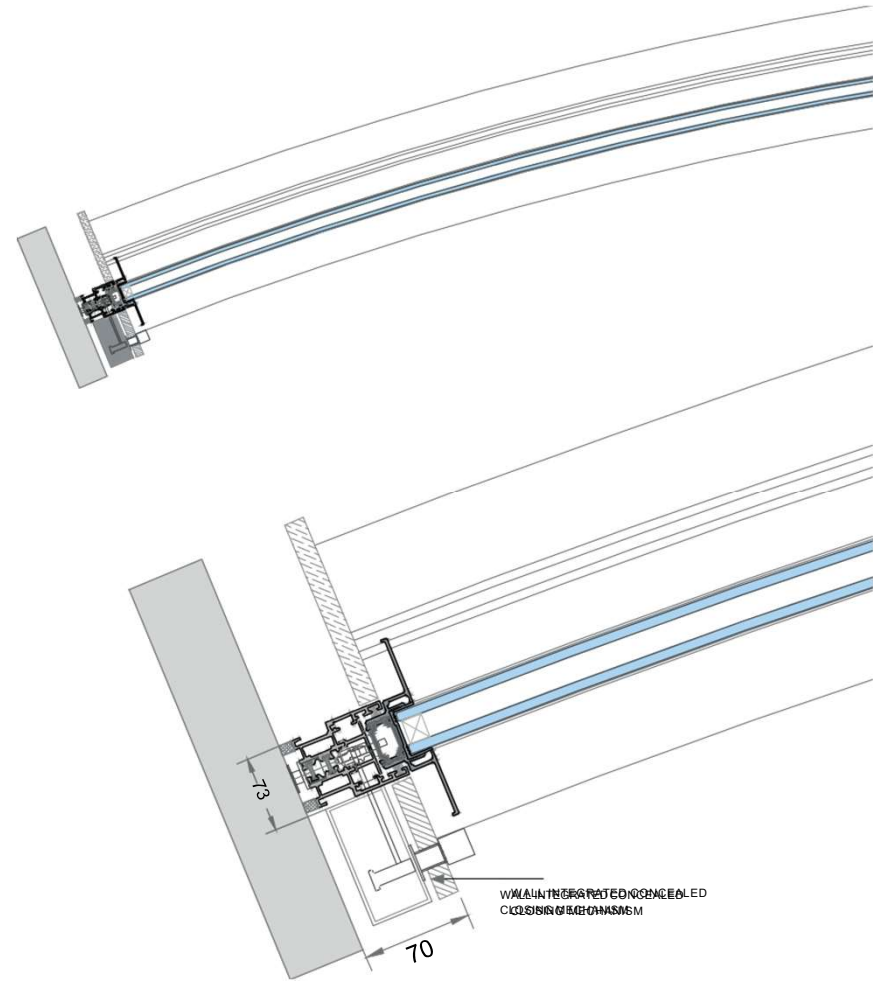
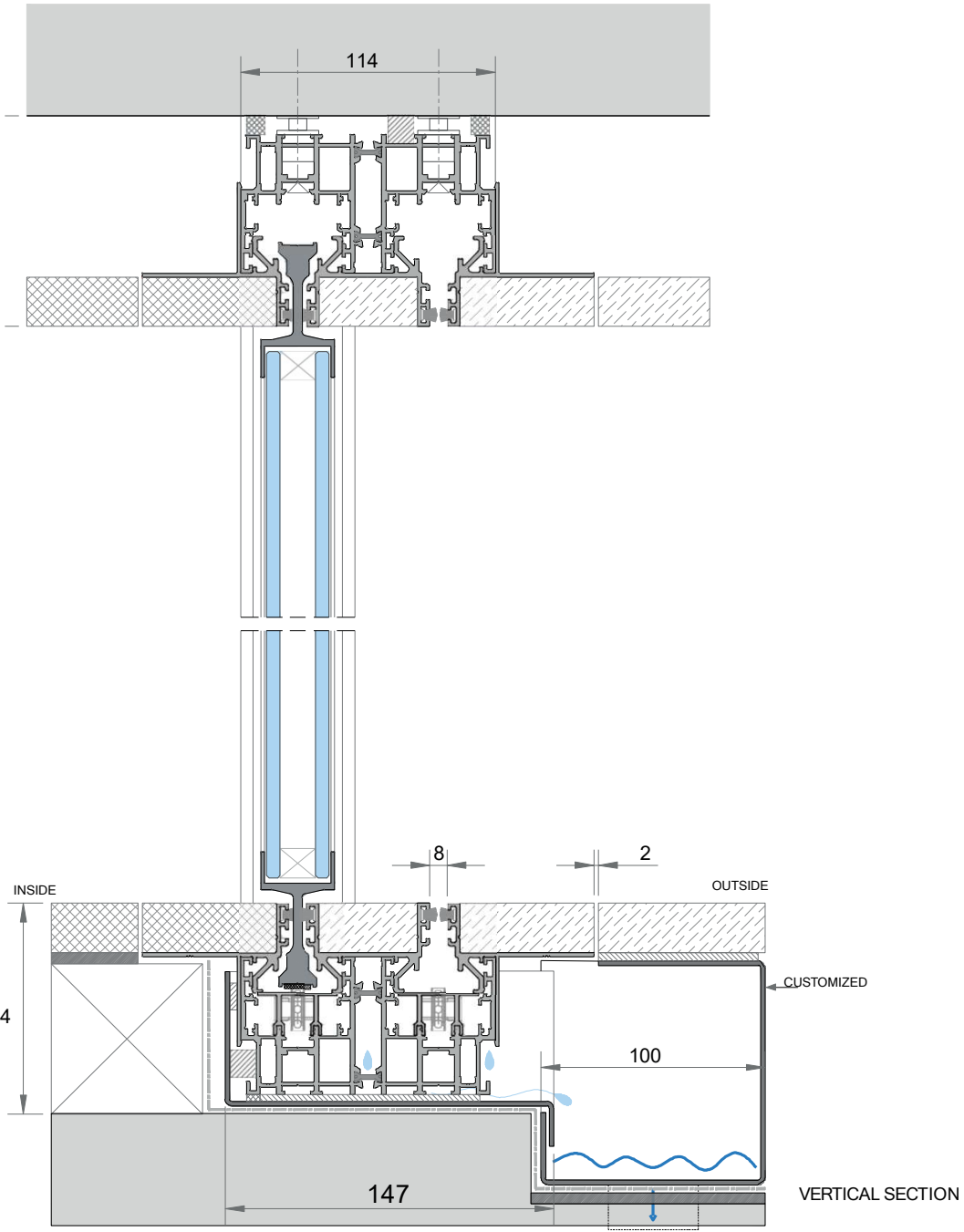

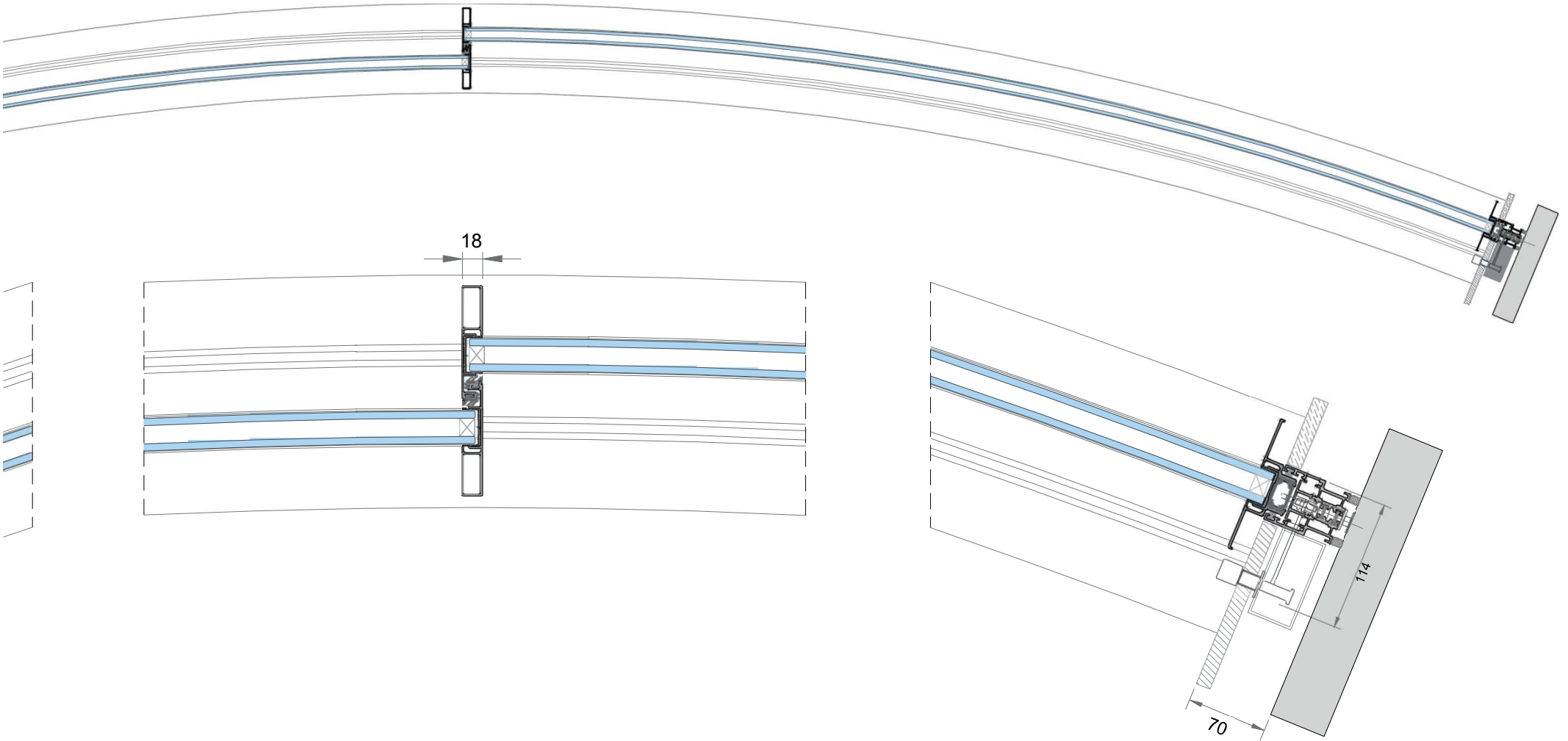

HORIZONTAL SECTION

HYINV

pat. #2017/195064 A1

IT'S THERE, CAN YOU SEE IT?

You can't see it, but trust us the aluminium is there. This innovative sliding system offers the smallest aluminium view of the market and offers no obstacles between interior and exterior. We also ensured that the existing gap in the sliding window is narrower than a lady's high heel, hides the bearings and avoids the accumulation of debris.

Its a very reliable system with no maintenance needed and can also be manually or automatically operated.

1. Main Frame
2. Central Mullion
3. Glass
4. Drainage System
5. Inox Gutter
6. Interior Finish

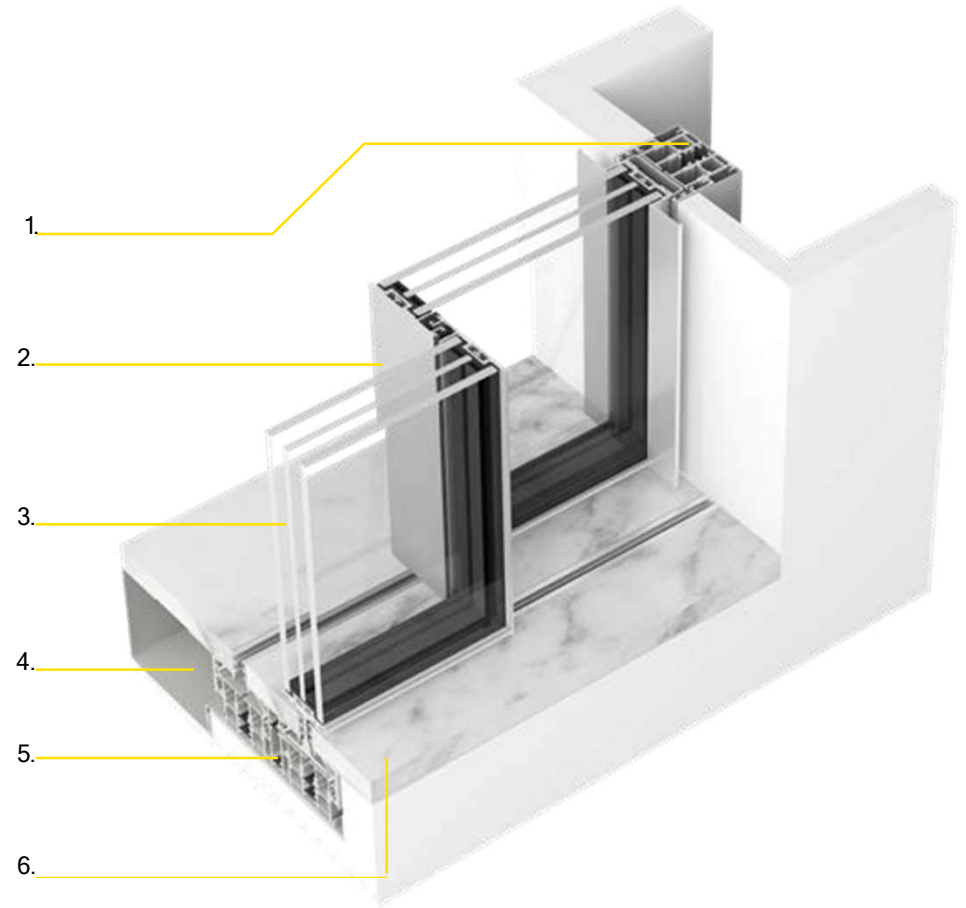

MEASUREMENTS

Maximum Width	Under consultation	Maximum Weight	1000Kg/ML	Maximum Box for Glass	48mm
Maximum Height	3000mm	Opening Options	Customized Corner Motorized		
Glazing (Maximum Area)	9m ²				

Indicative Opening Types

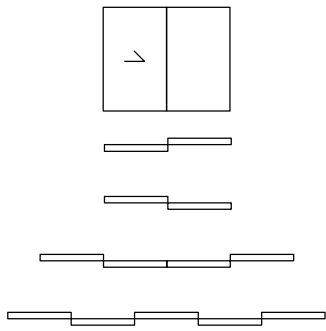

Bi-Rail

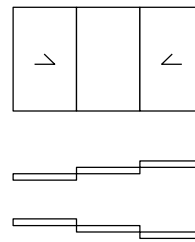

Tri-Rail

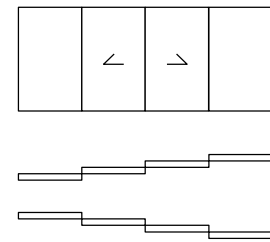

Quadri-Rail

SURFAC
TREATMENT

- HYLINE Colour Essentials (Ral Colores STD)
- HYLINE Natural Metals (Qualanod EURAS Class 2 STD)
- HYLINE Advanced Coating (Hiper Durable Finishings)
- HYLINE Luxury Collection under Qualicoat Seaside 5 standards

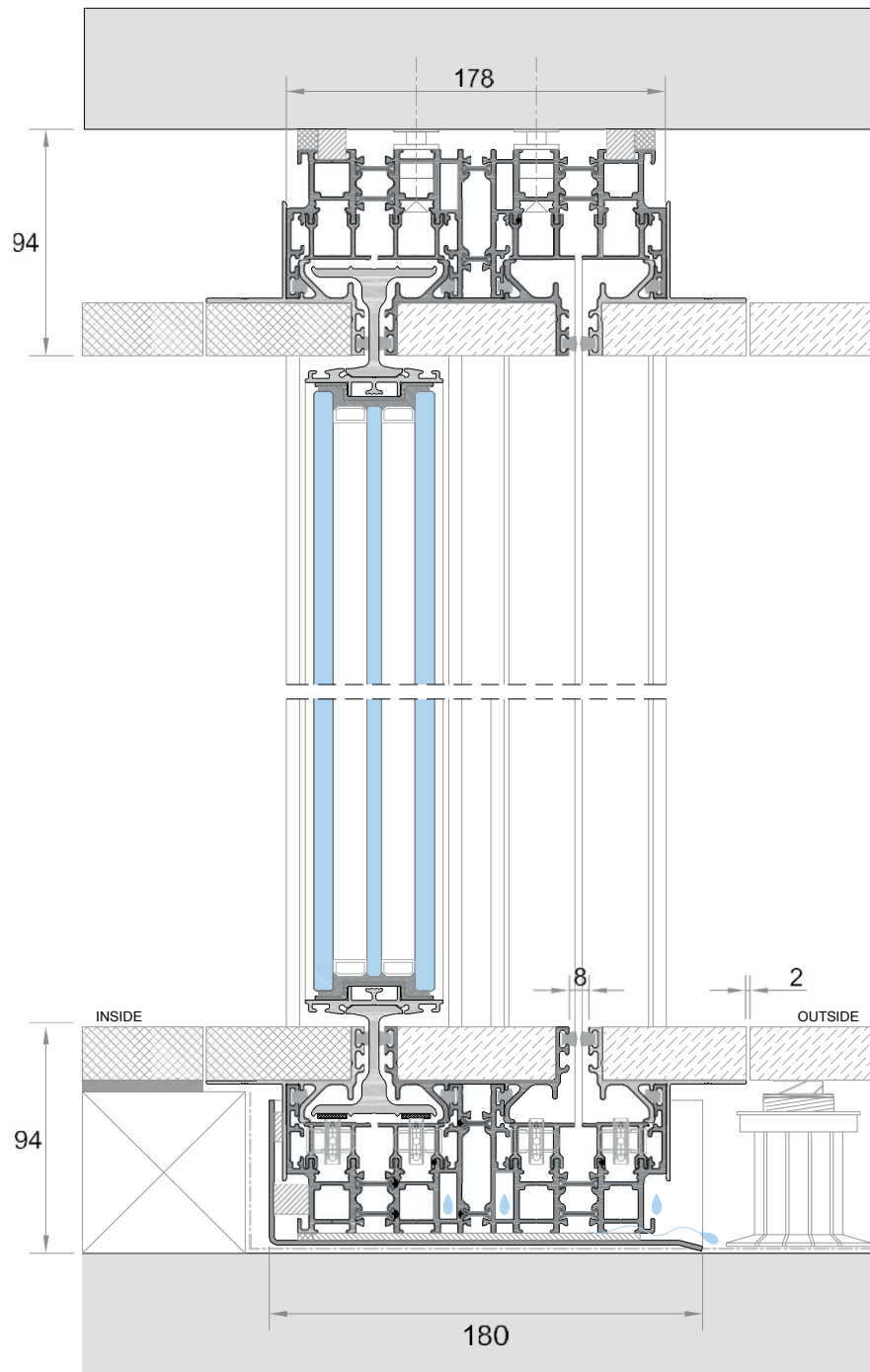

VERTICAL SECTION

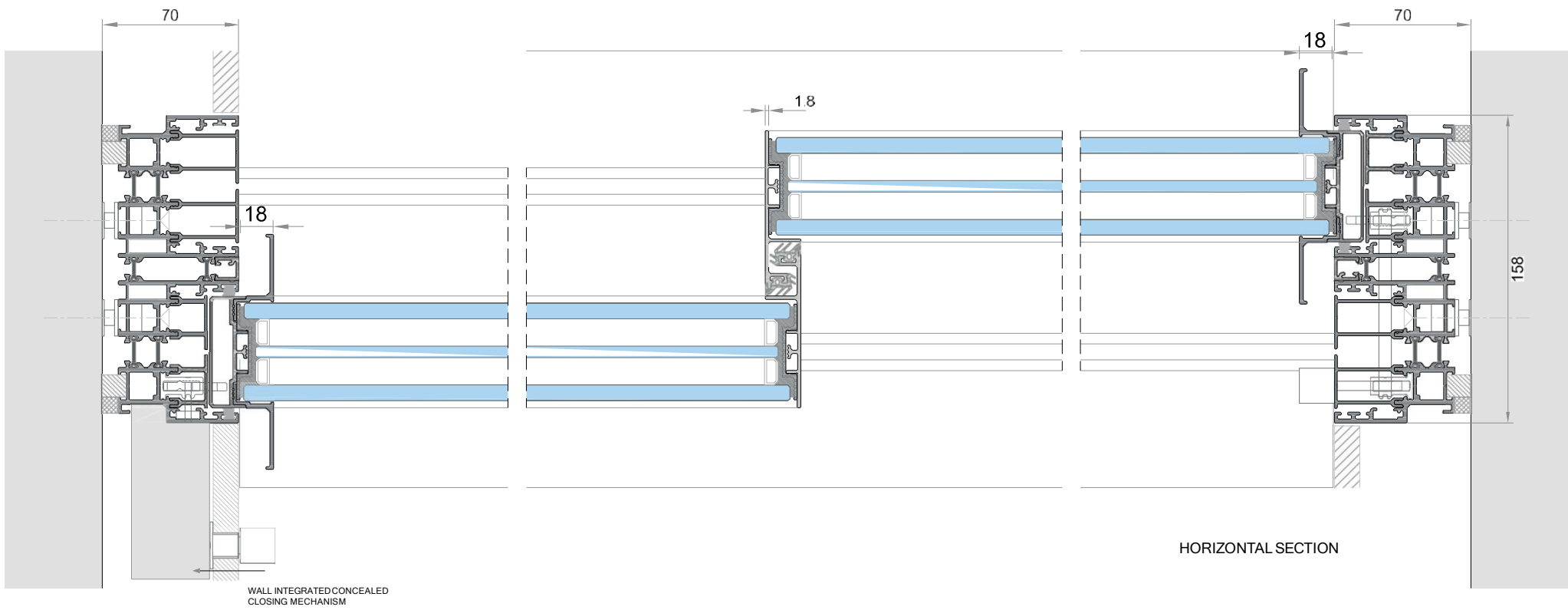

HYWIN+

1. Main Frame
2. Central Mullion 18mm
3. Glass

HYWIN+ is the Minimalist T&T/TBT dry glazing window, fully compatible and integrated with HYLINe sliders offer.

18mm of aluminum exterior periferic view. Centered handle 18mm. Maximum dimensions with a minimalist approach, up to 2,8m high and up to 1,7m wide, restrained to a maximum sash weight of 180kg.

Robust structural solution, slim straight lines with concealed accesories.

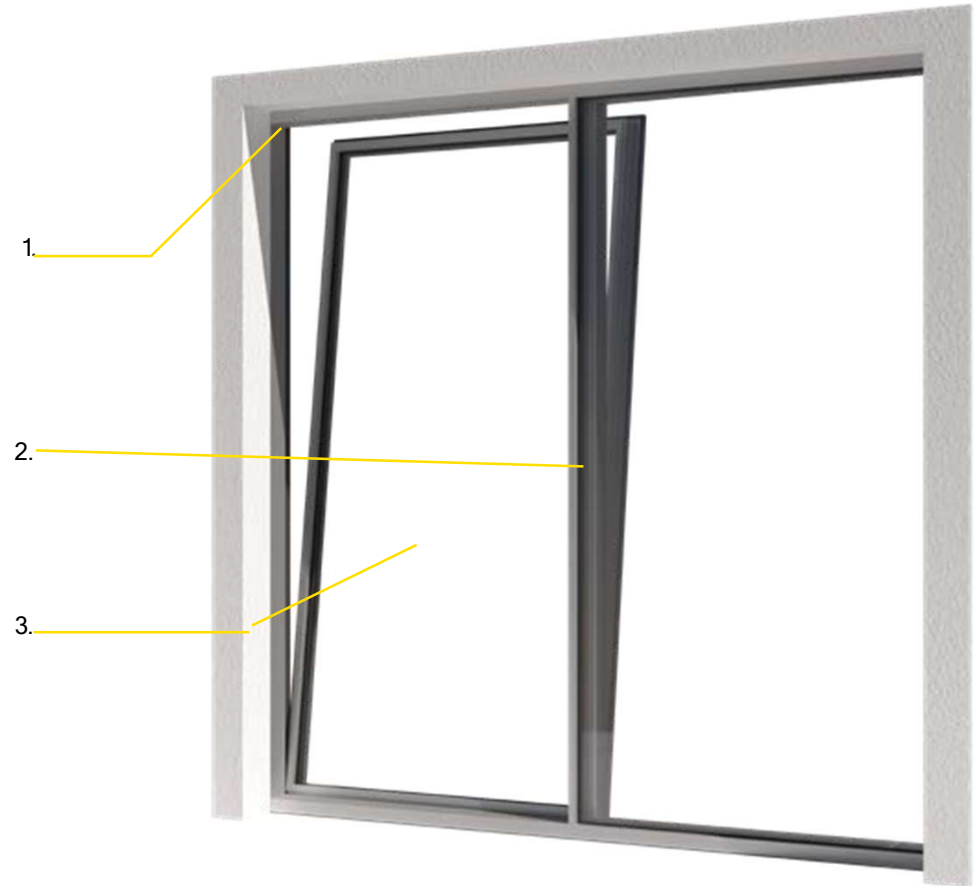

MEASUREMENTS

Maximum Width 1700mm

Maximum Height 2800mm

Glazing
(Maximum Area)

Maximum Weight

180Kg/ SASH

Opening Options

1 vent inward opening.
1 vent T&T and TBT with safety blocking key handle.
Modular multi-vent glass panels.

Maximum Box for Glass

38mm

Indicative Opening Types

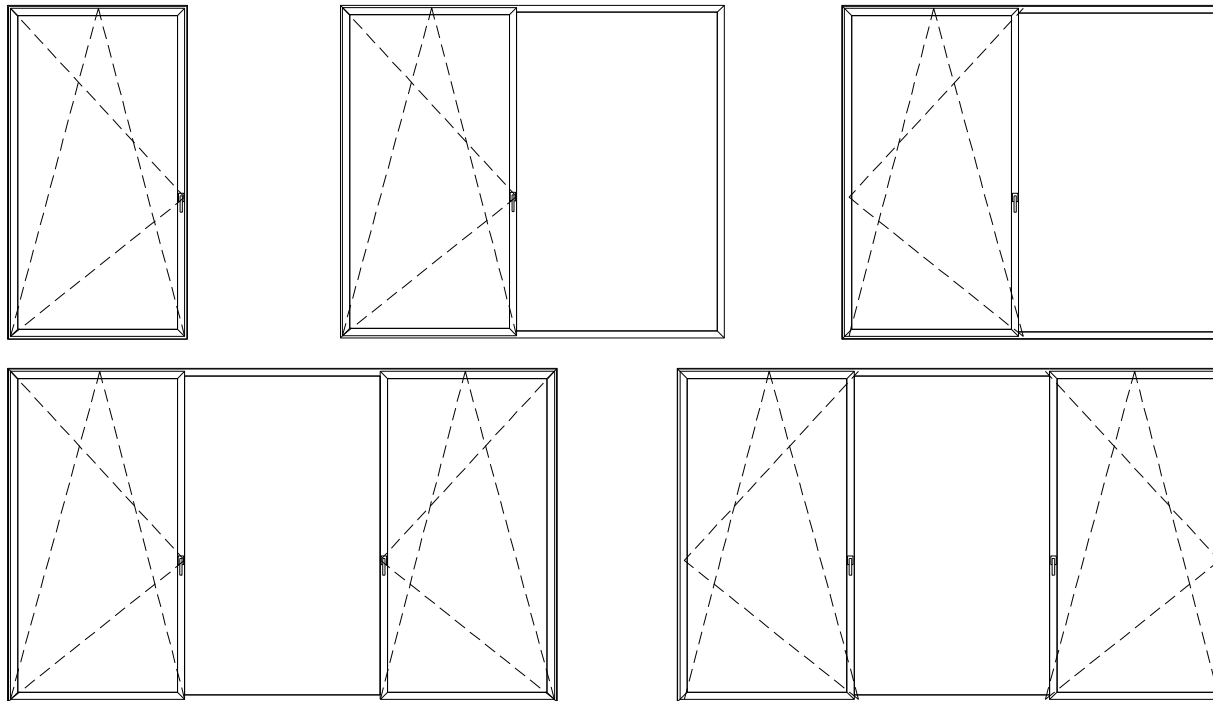

SURFAC
TREATMENT

- HYLINE Colour Essentials (Ral Colores STD)
- HYLINE Natural Metals (Qualanod EURAS Class 2 STD)
- HYLINE Advanced Coating (Hiper Durable Finishings)
- HYLINE Luxury Collection under Qualicoat Seaside 5 Standards

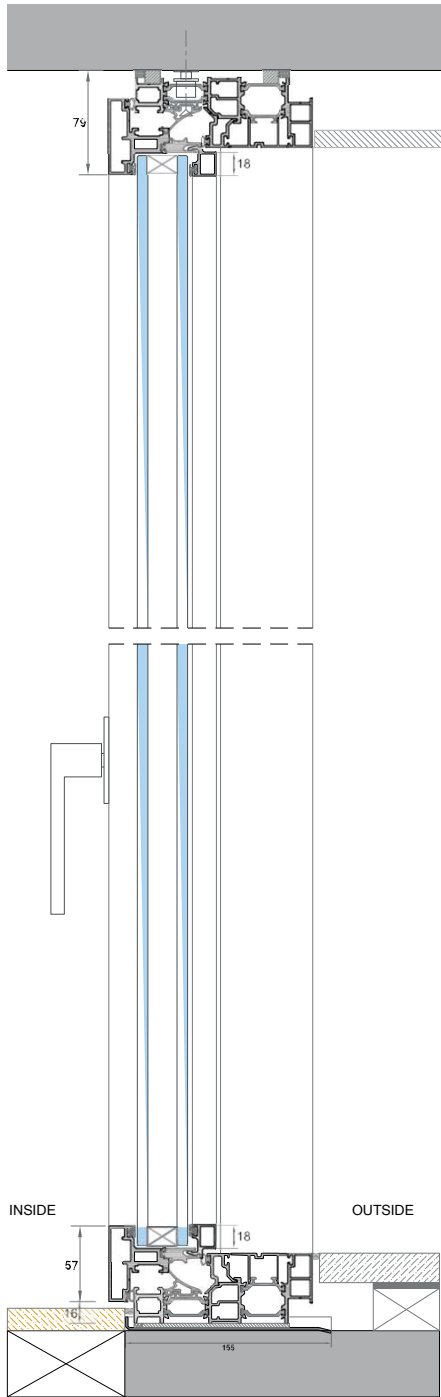

VERTICAL SECTION BB

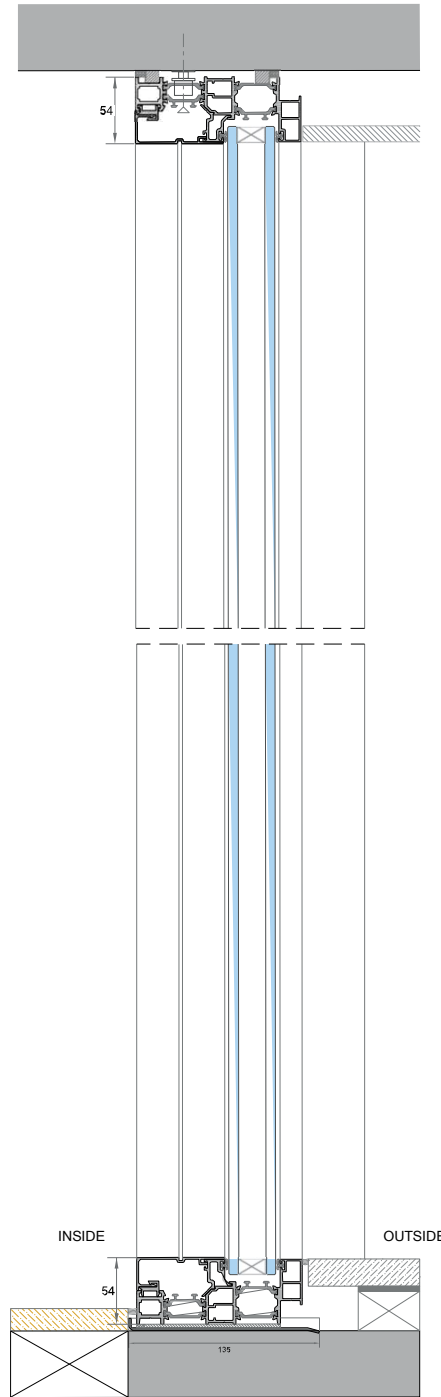

VERTICAL SECTION CC

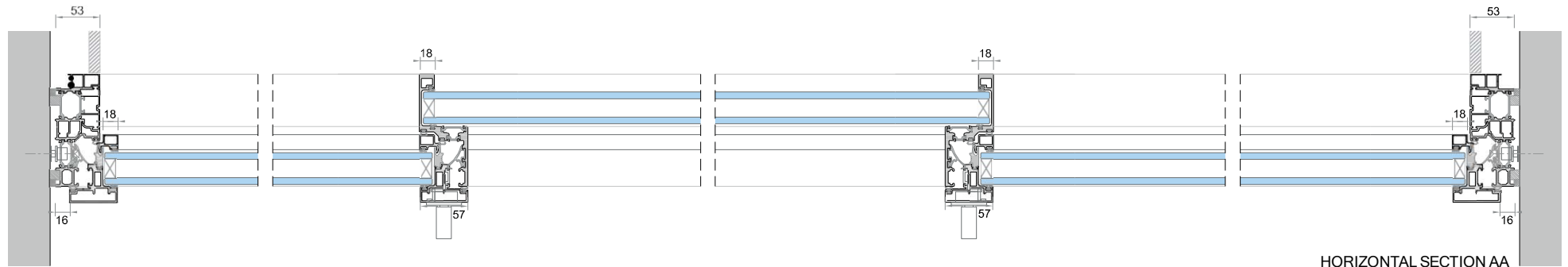
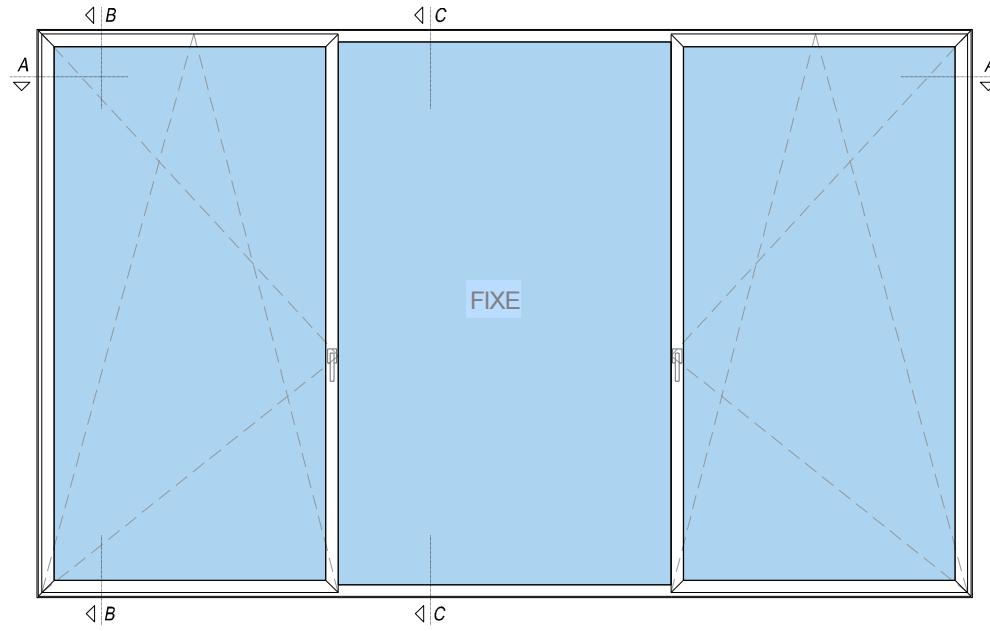

HORIZONTAL SECTION AA

HYWOOD

THE SLIMMEST ALU-WOOD SLIDER

1. Main Frame
2. Central Mullion
3. Glass
4. Drainage System
5. Inox Gutter
6. Interior Finish

Our answer to fulfill the desire for slim lines, wide openings and the touch and feel of wood! With a 48mm aluminium view for the frame and central mullion, this is the slimmest alu-wood solution in the market.

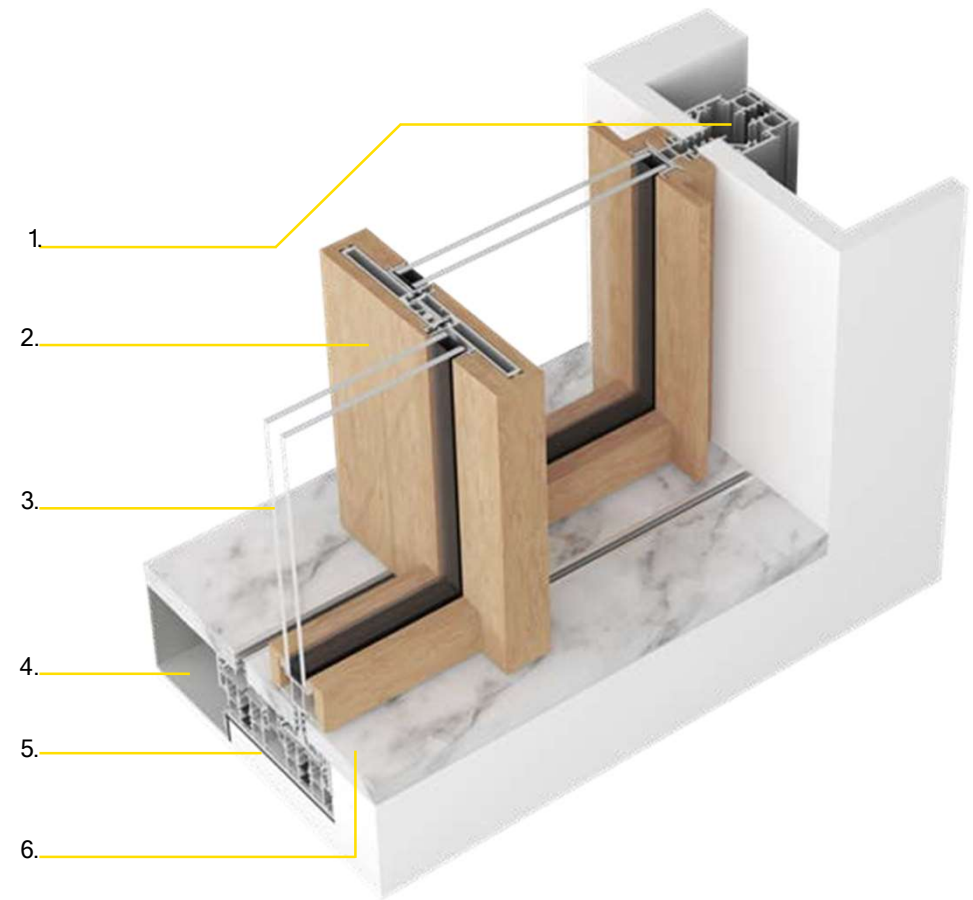

MEASUREMENTS

Maximum Width 3000mm

Maximum Height 3000mm

Glazing
(Maximum Area) 9m²

Maximum Weight 500Kg PER VENT

Opening Options
Customized
Corner
Motorized

Maximum Box for Glass 28mm
38mm
44mm

Indicative Opening Types

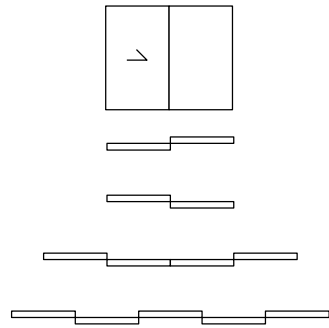

Bi-Rail

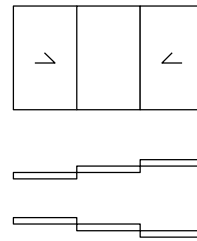

Tri-Rail

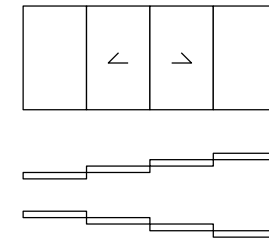

Quadri-Rail

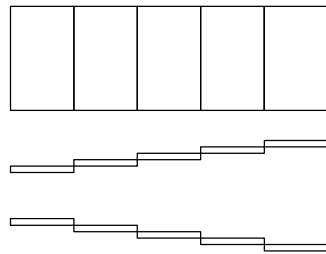

Penta-Rail

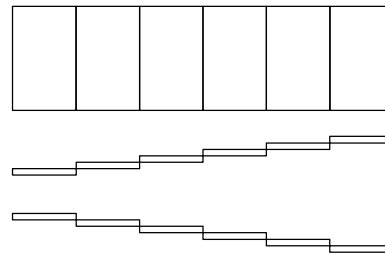

Hexa-Rail

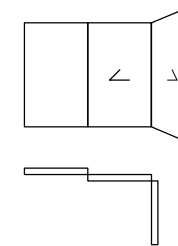

Corner

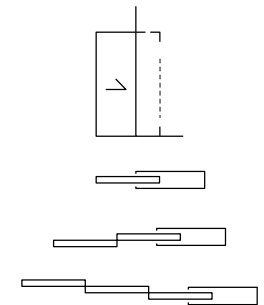

Pocket

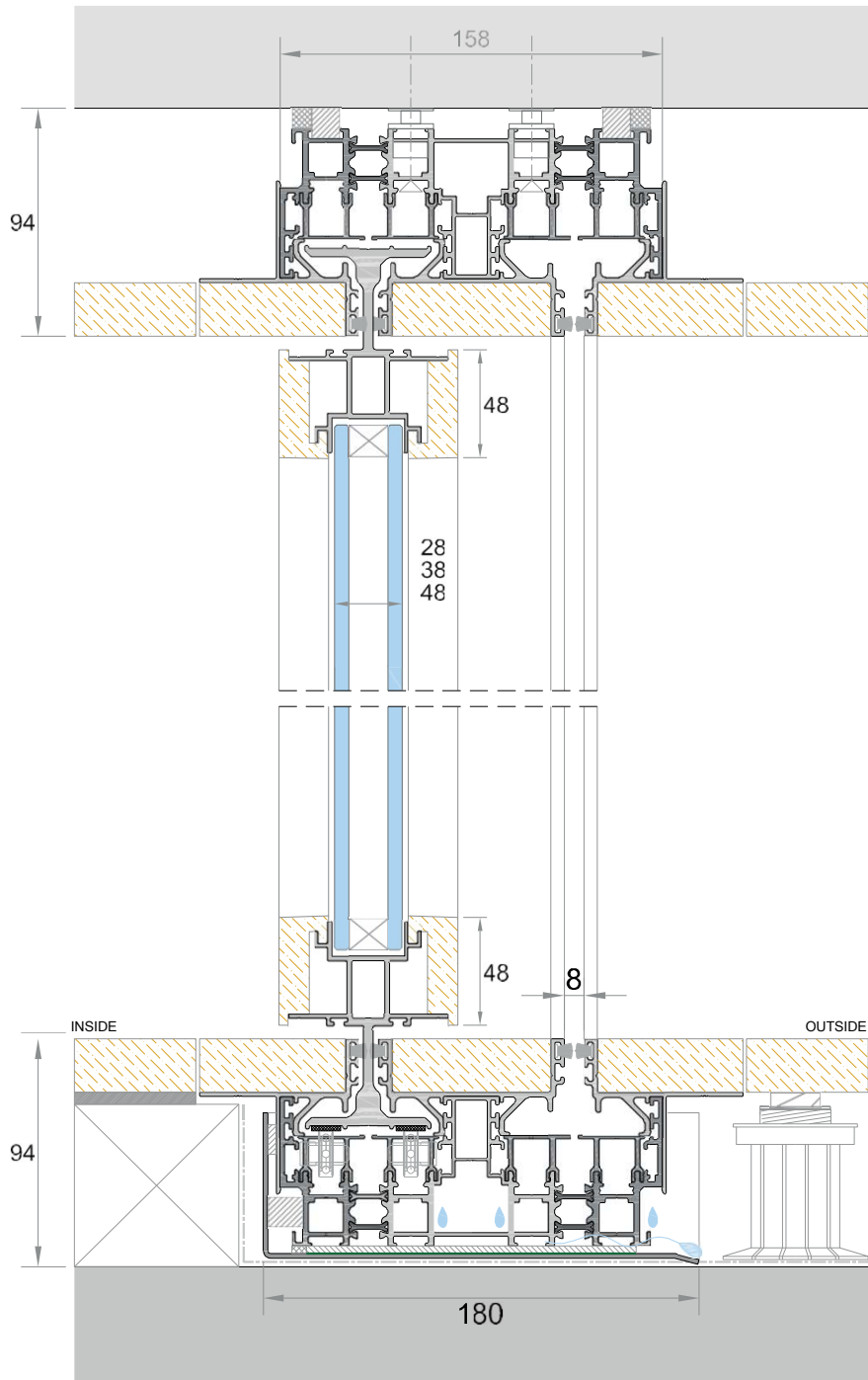

VERTICAL SECTION

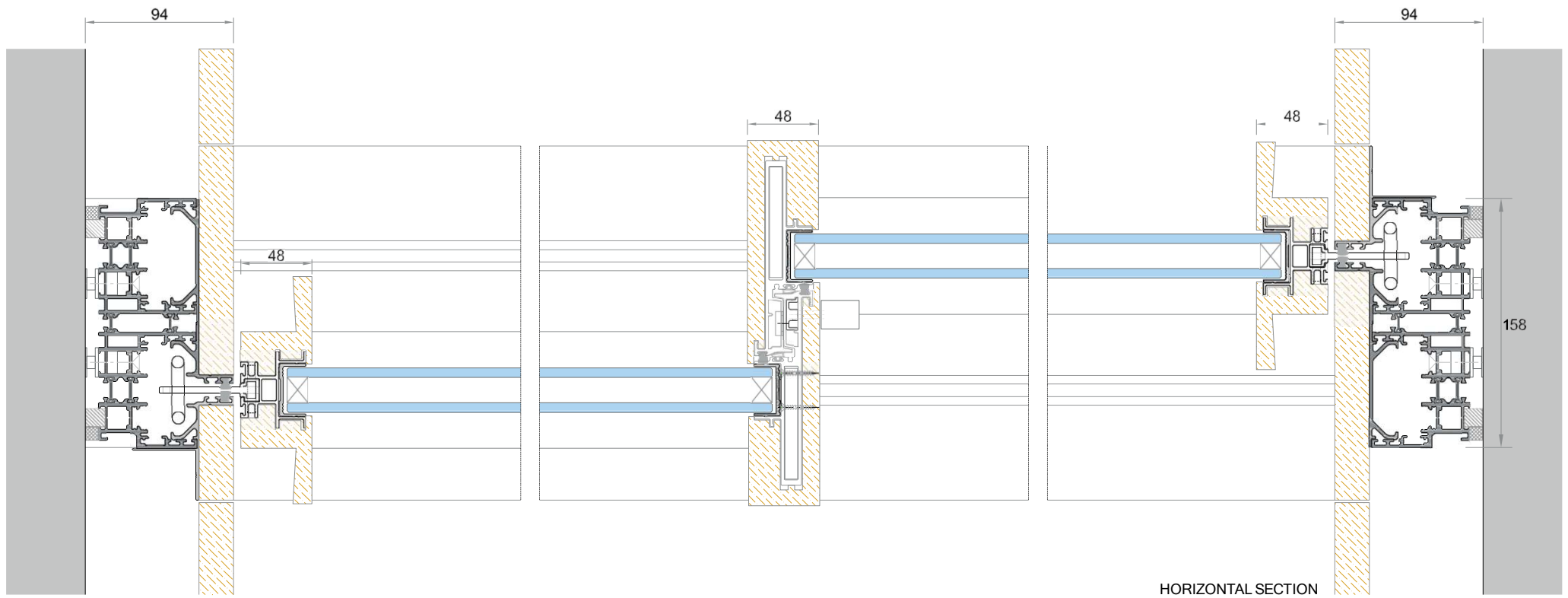

HORIZONTAL SECTION

HYSTYLE

1. Opening Frame
2. Fixed Frame
3. Glass
4. Exterior finish

HYSTYLE the ultimate dry glazing minimalist and multi-modular HYLINE casement system, provides an inward and outward opening windows and doors, with a 18mm frame view, fully compatible with HYLINE product range, integrating concealed hinges, concealed draining frame, with a design approach based on the slimmest steel frames appearance, with a comprehensive and complete range of opening possibilities.

Available in a wide range of anodized surface treatment under EURAS class 2 (gold finish, bronze finish, brushed and polished inox look, natural aluminium) and on RAL powder coating colour pattern and Hyline Advanced Coatings - Ultra-Durable Finishing's under Qualicoat Seaside Standard.

HYSTYLE provides a complete and flexible solution to answer to project specification both on tropical climate regions (Latin America, Africa and India) and on cold climate regions (USA, Europe) providing solutions to install double and triple glass (Uw of lower than 1.4 W/m²K for a standard window section or 0.246Btu/hr-sf-°F).

Contemporary handle configurations, available on the two handles model collections HYLINE luxury collection and HYLINE classic line, that take us to the past with elegance. Despite the ultra slim approach of the product, HYSTYLE was developed to achieve outstanding performance both on AEV performance, thermal insulation and acoustics isolation, on maximum execution dimension, up to 4m² of operating sash.

HYSTYLE is a new generation and a new image that will definitely surprise you.

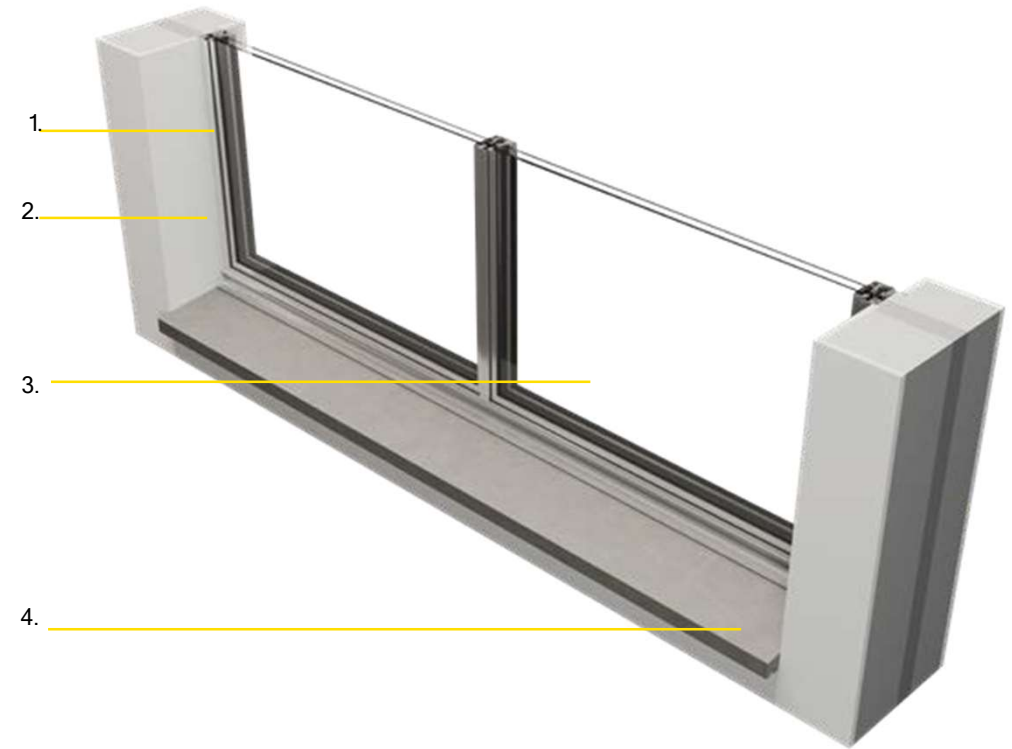

MEASUREMENTS

Maximum Width	1700mm
Maximum Height	2800mm
Glazing (Maximum Area)	Monolithic, Double & Triple glass

Maximum Weight	180Kg/ML
Opening Options	1 vent and 2 vents inward and outward opening. 1 vent and 2 vents T&T and TBT with safety blocking key handle. Modular multi-vent glass panels. 1 and 2 sash door, inward and outward opening with multi-point security lock.

Maximum Box for Glass	28mm 38mm 48mm
-----------------------	----------------------

Indicative Opening Types

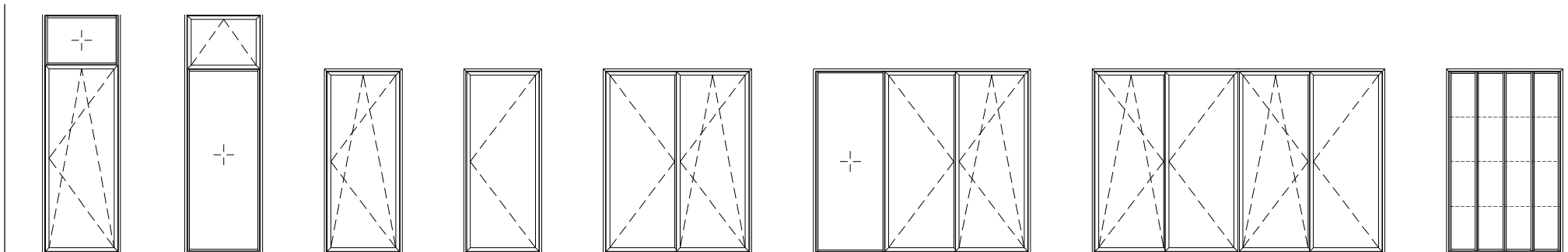

OPENING TYPOLOGY

Oscillation logical manoeuvre TBT (Tilt Before Turn) and Traditional Tilt After Turn (TAT 1) and 2 sashes

French opening 1 sash and 2 sashes

Microventilation opening

Tilting opening

1 and 2-sash window frame with sill for access for people with reduced mobility

1 and 2-sash pedestrian door with multipoint lock

1 and 2-sash opening door with lock

Design lines for switchgear accessories (all switchgear accessories including hinge are provided in the frame color):

HYLINE DESIGN handles.

Profile design lines:

Straight

Angle (45 degrees)

Steel Look (L angle profile)

SURFAC TREATMENT

HYLINE Colour Essentials (Ral Colores STD)

HYLINE Natural Metals (Qualanod EURAS Class 2 STD)

HYLINE Advanced Coating (Hiper Durable Finishings)

HYLINE Luxury Collection under Qualicoat Seaside Standards

TYPE OF INSTALLATION

In a tunnel (indoor and outdoor insulation (ETICS))

Installation in interior insulation by fixing claw and half-turn clameaux

Installation in external insulation by fixing claw and half-turn clameaux

Installation in interior wall light with minimalist framing profile for plasterboard

DRAIN TECHNOLOGY

Hidden drainage (gutterless)

Drainage by metal deflector in the color of the frame bone

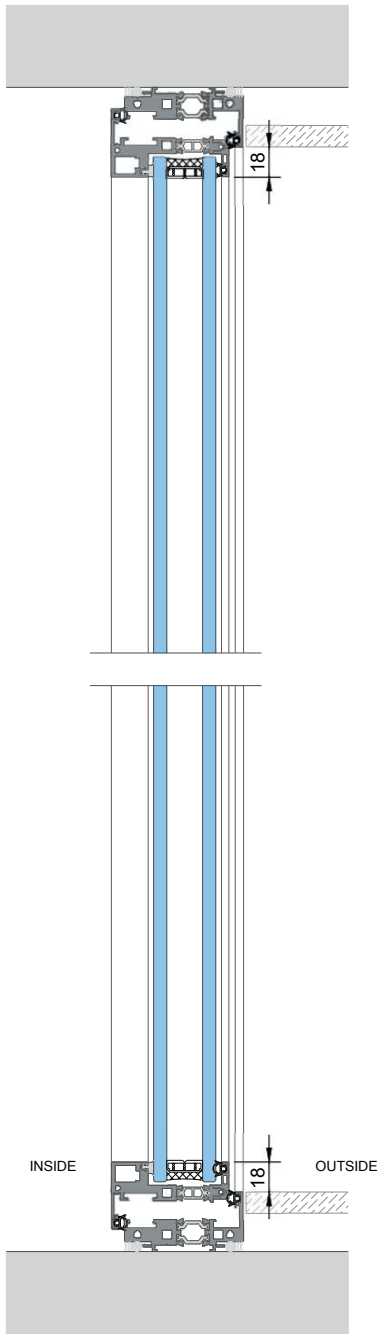

VERTICAL SECTION BB

PROFILE DESIGN
FEATURES:

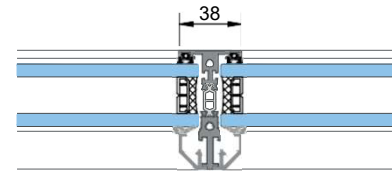
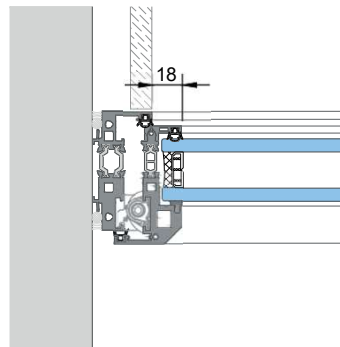
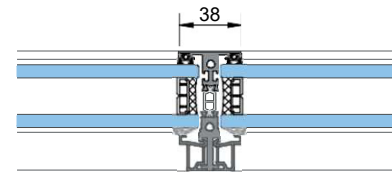
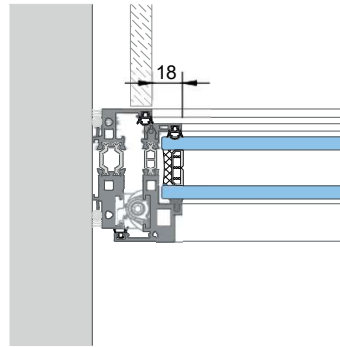
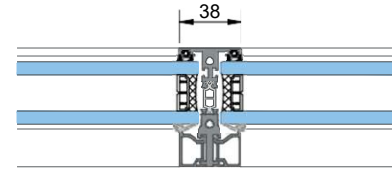
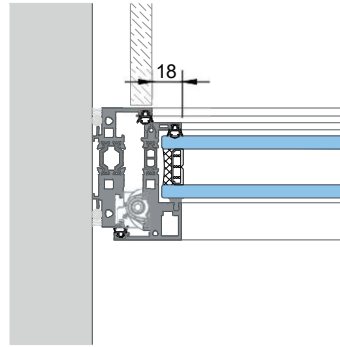

HYLINE INSULATED SIMULATED DIVIDED LITES (SDL) PROFILES

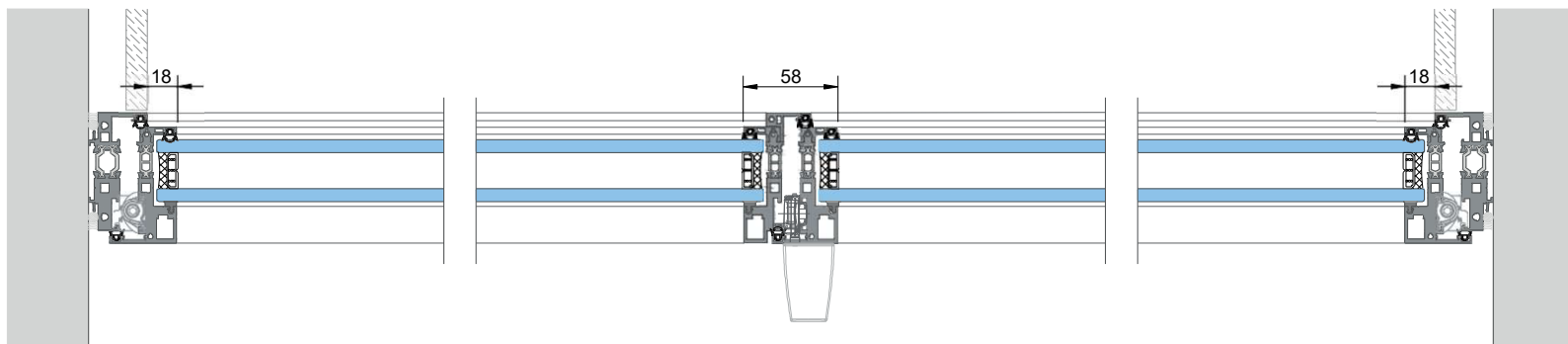
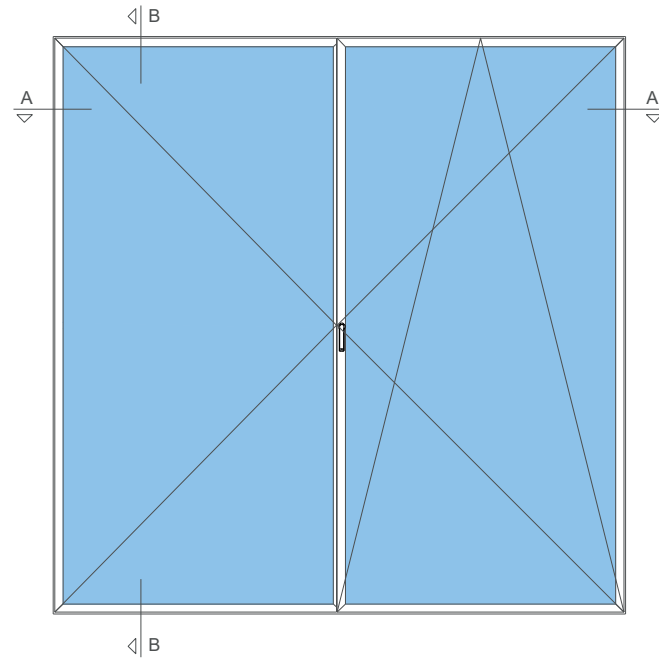
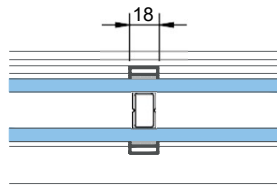

HORIZONTAL SECTION AA



GET IN TOUCH

Get in touch with us.

**Let's create visibility
together...**







ALU AND GLASS

Premium **Architectural Aluminium** Building Systems

WWW.HYLINEPS.COM

sales@aluandglass.com

TEL: +30 69 4576 8894 (also WhatsApp & Viber)

ALU AND GLASS D.O.O.
(HYLINE PREMIUM SYSTEMS)

Belgrade office: Makenzijeva 37, 11000 Belgrade, SERBIA